



High Pressure Vertical Multistage Pumps - 50Hz



VERTICAL MULTISTAGE CENTRIFUGAL PUMPS - KM SERIES

Power Range	0.37 -110 kW
Version	1Ph - 230V, 50Hz AC 3Ph - 380-415V, 50Hz AC
Speed	2900 RPM
Protection	IP 55
Insulation Class	F Class
Duty	S1 (continuous)
Direction of Rotation	Clockwise viewed from driving end
Sealing	Mechanical Seal
Flange type	Round flange, PJE Coupling, Oval flange
Flange Standard	DIN Standard
Max. Liquid Temperature	-15 to +120°C
Max. Ambient Temperature	40°C
Max. Operating Pressure	30 Bar
Flow Range	upto 250m ³ /h
Head Range	upto 300m

Group Curves

Pump performance range

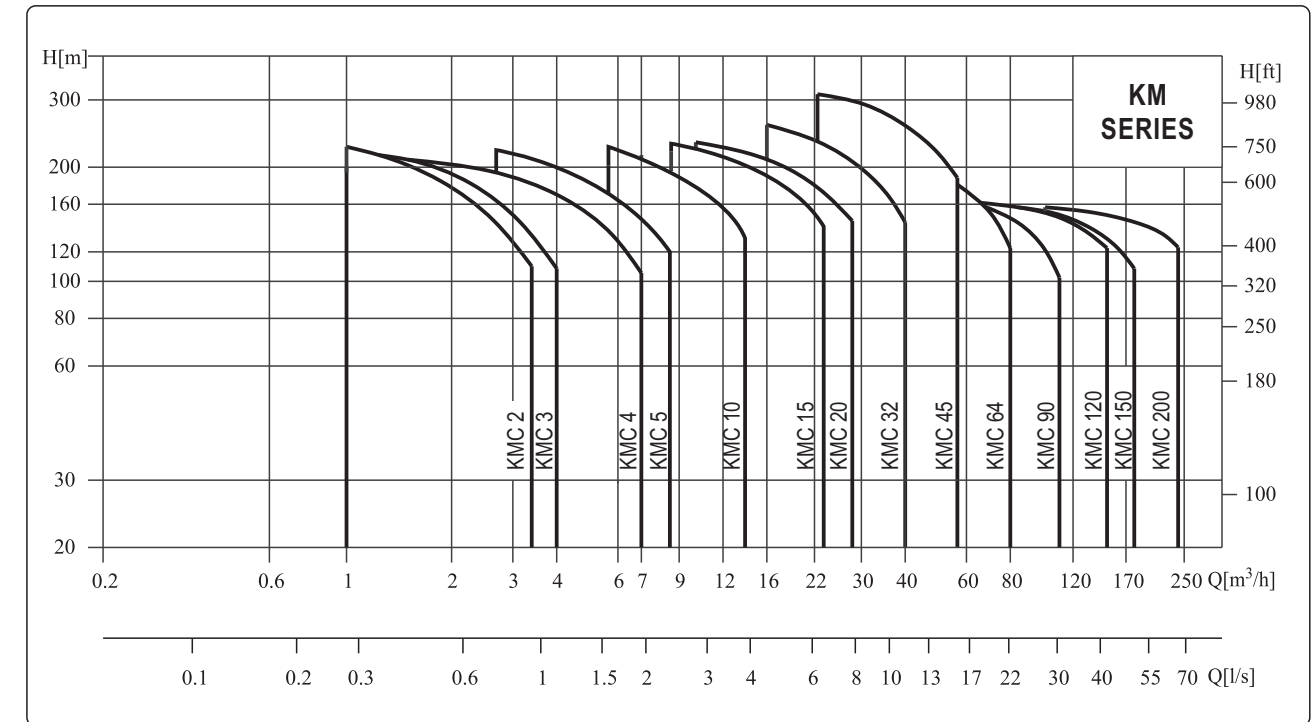

Vertical Multistage Pumps

XXX - (S)(X)X / XX (X) X XXX

KM - Vertical Multistage Pump

Materials of Construction

C= CI Pump head & Suc. Del. Port
S= Complete SS304 Const.
N= Complete SS316 Const.

Applicable only for 60Hz

Rated Flow in m³/h
1 - 1m³/h, 32 - 32m³/h

Number of Stages

Applicable when Trimmed Impeller used
R1 = 1 Trimmed Impeller, R2 = 2 Trimmed Impeller

Applicable only for high Eff. Motors

2 = IE2 Motor
3 = IE3 Motor

Voltage (Except for 1Ph 230V & 3Ph 380V)

D = 220V, K = 415V, N = 525V

Method of Starting

S: 1Ph - CSCR
T: 3Ph - D.O.L
D: 3Ph - S.D.

Applicable only if with Port Connection
P= PJE Coupling, O = Oval Flange

MATERIALS OF CONSTRUCTION

Part Name	KMC	KMS	KMN
Pump Housing	Cast Iron	SS 304	SS 316
Pump Shell	SS 304	SS 304	SS 316
Impeller	SS 304	SS 304	SS 316
Diffuser Casing	SS 304	SS 304	SS 316
Pump Shaft	SS 304 / 431	SS 304 / 431	SS 316/329
Mechanical Seal	SiC / SiC	SiC / SiC	SiC / SiC
Coupling	M.S / C.I.	M.S / C.I.	M.S / C.I.
Wearing Ring	Teflon	Teflon	Teflon
Bush	SiC / SiC	SiC / SiC	SiC / SiC
Split Cone	SS 304	SS 304	SS 316
Split Cone Nut	SS 304	SS 304	SS 316
Flange	Cast Iron	SS 304	SS 316
Neck Ring	SS 304	SS 304	SS 316
"O" Ring	EPDM	EPDM	EPDM
Base Plate	NA	Cast Iron	Cast Iron

Exploded View: 2 m³/h, 3 m³/h, 4 m³/h, 5 m³/h

Exploded View: 10 m³/h, 15 m³/h, 20 m³/h

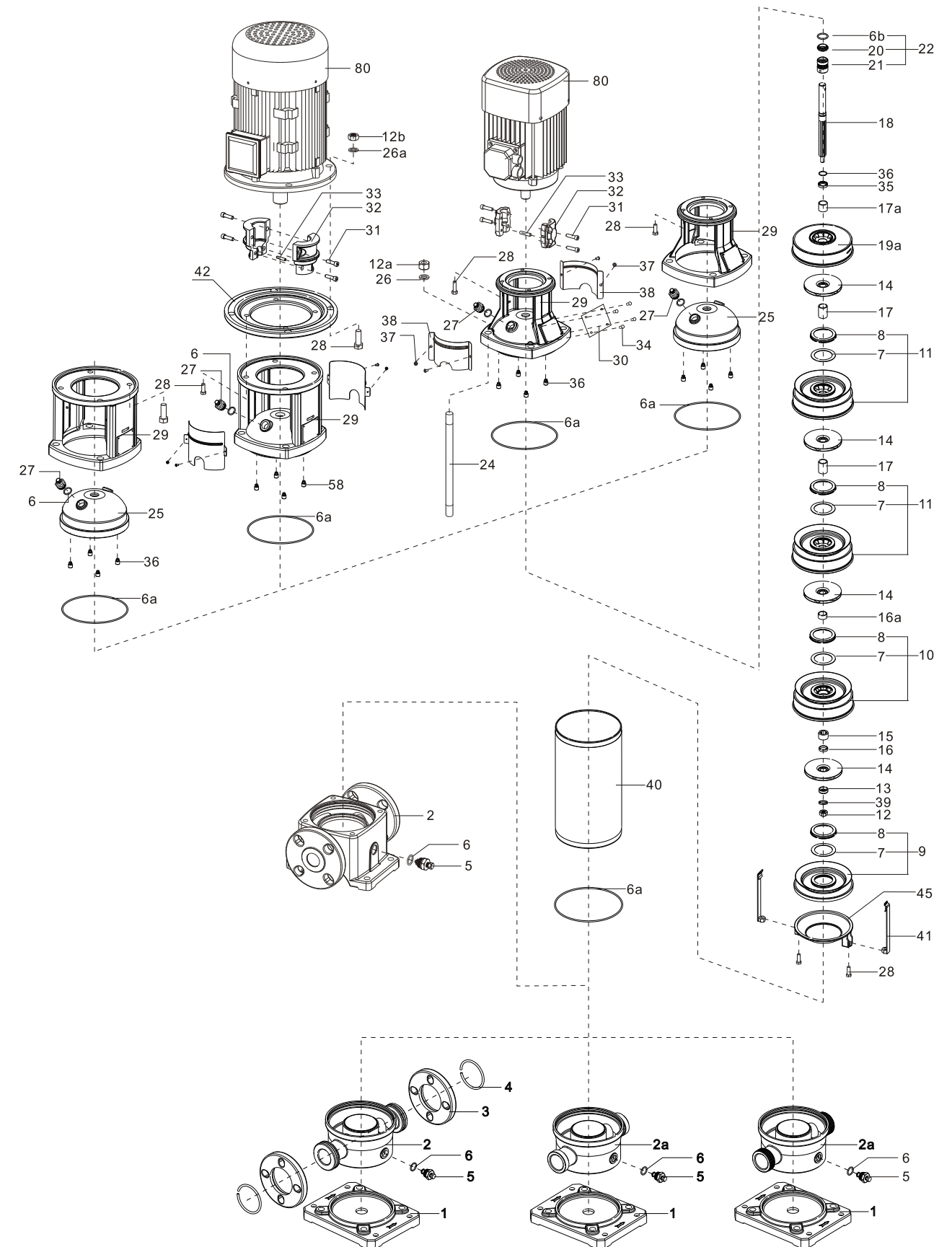
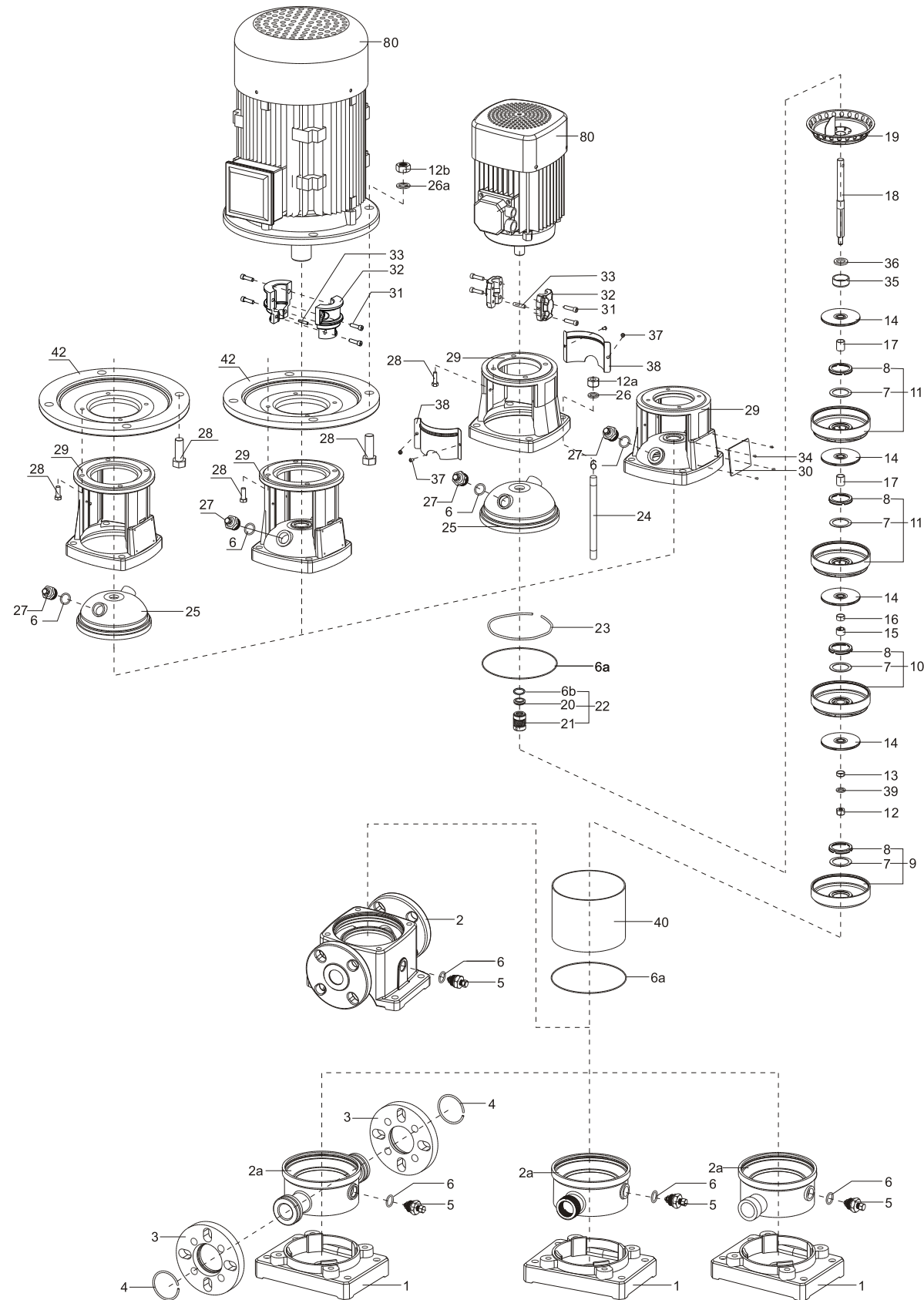

Exploded View: 32m³/h, 45m³/h, 65m³/h & 90m³/h

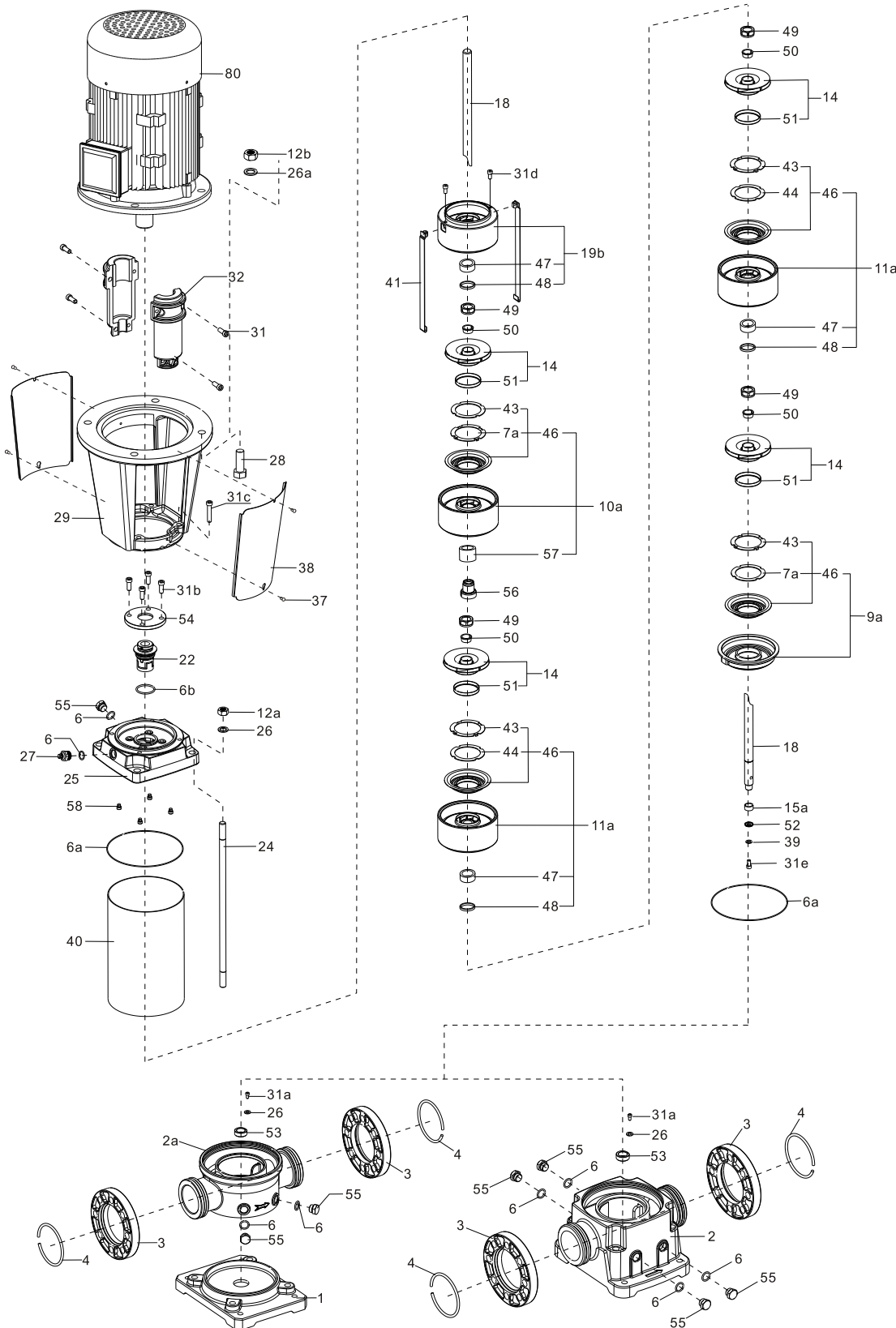

No.	Description	Material	No.	Description	Material
1	Base	Cast iron	27	Vent plug	SS304
2	Pump housing	Cast iron	28	Bolt	Zinc
2a	Pump housing	SS304 /SS316	28a	Bolt	Zinc
3	Flange	Cast iron	29	Motor frame	Cast iron
4	Circlip	SS201	30	Nameplate	Aluminum
5	Drainplug	SS304	31	Screw	Zinc
6	O-ring	NBR	31a	Screw	Zinc
6a	O-ring	NBR	31b	Screw	Zinc
6b	O-ring	NBR	31c	Screw	Zinc
7	Seal	PTFE	31d	Screw	Zinc
7a	Seal	PTFE	31e	Screw	Zinc
8	Seal	SS304	32	Shaft coupling	Ductile Iron
9	Inlet section	SS304	33	Screw	Zinc
9a	Inlet section	SS304	34	Nail	M62
10	Support diffuser	SS304	35	Clip sleeve	SS304
10a	Support diffuser	SS304	36	Clip ring	SS304
11	Diffuser	SS304	37	Screw	SS304
11a	Diffuser	SS304	38	Coupling guard	SS304
12	Nut	Zinc	39	Spring pad	SS304
12a	Nut	Zinc	40	Outer sleeve	SS304
12b	Nut	Zinc	41	Link group	SS304
13	Impeller sleeve	SS304	42	Motor flange	Cast iron
14	Impeller	SS304	43	Gasket	NBR
15	Bearing sleeve	Tungsten carbide	44	Oval flange	Cast iron
15a	Bearing sleeve	Tungsten carbide	45	Fix cover	SS304
16	Short sleeve I	SS304	46	Neck ring	SS304
16a	Short sleeve II	SS304	47	Liner	PTFE
17	1cm sleeve	SS304	48	Support ring	SS304
17a	1cm sleeve	SS304	49	Nut	SS304
18	Shift	SS431	50	Split Cone	SS304
19	Outlet section	SS304	51	Wear ring for impeller	SS304
19a	Outlet section	SS304	52	Press sleeve	SS304
19b	Outlet section	SS304	53	Slide bearing	Tungsten Carbide
20	Stationary seal ring	Carbon	54	Gland cover	Cast steel
21	Guide Bush	Tungsten carbide	55	Drain Plug	SS304
22	Mechanical seal	Carbon/tungsten carbide/viton	56	Bearing sleeve	Tungsten carbide + SS304
23	Snap ring	SS304	57	Slide bearing	Tungsten carbide
24	Bolt	Zinc	80	Motor	
25	Pump cover	SS304			
26	Washer	SS304			

Exploded View: 120m³/h, 150m³/h, 200m³/h

KM Series

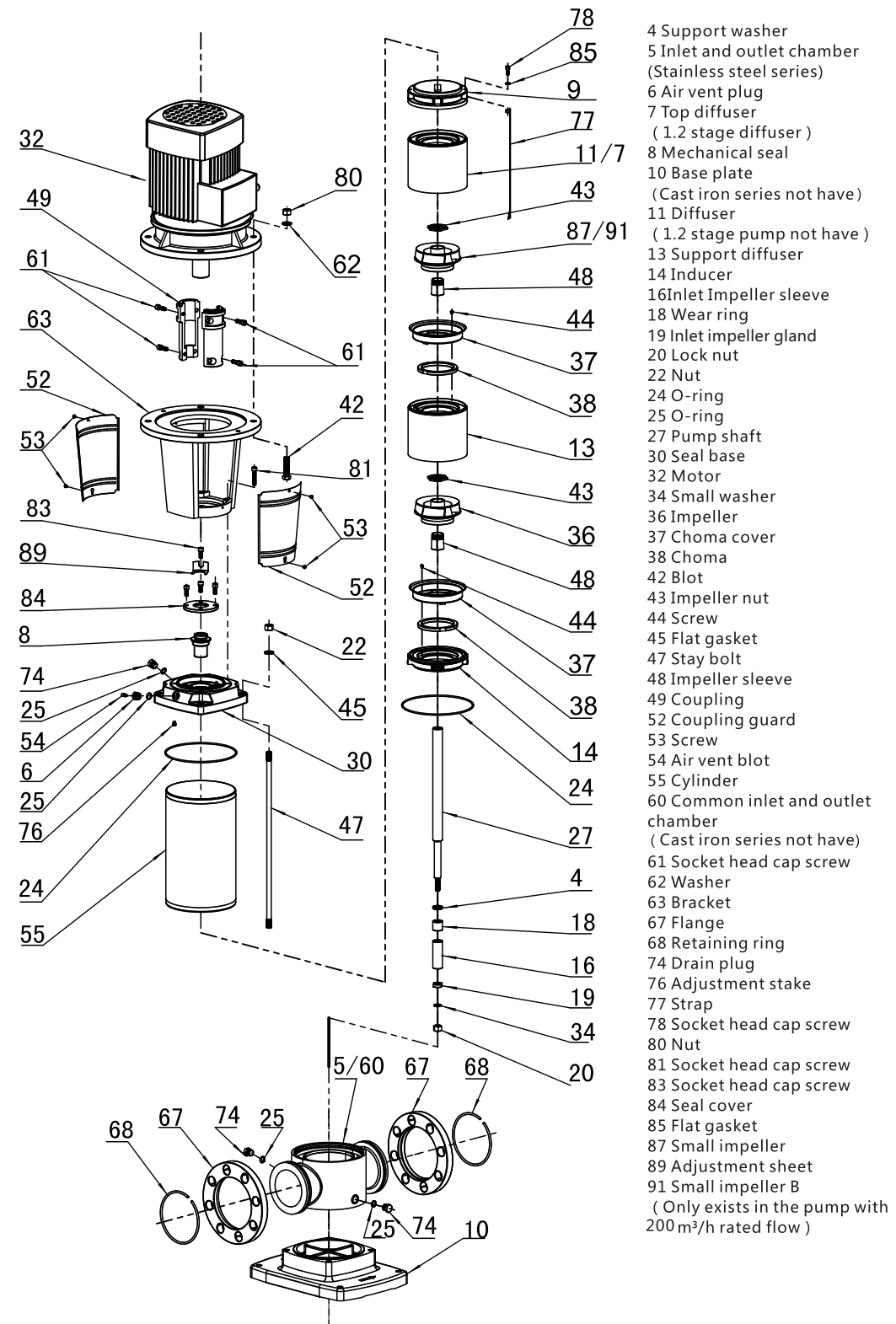

Parameter	KMC 2	KMC 3	KMC 4	KMC 5	KMC 10	KMC 15	KMC 20
Rated flow rate [m ³ /h]	2	3	4	5	10	15	20
Rated flow rate [l/s]	0.56	0.83	1.1	1.39	2.78	4.17	5.6
Flow rate [m ³ /h]	1~3.5	1.2~4	1.5~7	2.5~8.5	5~13	8~23	10~28
Flow rate [l/s]	0.28~0.97	0.33~1.1	0.42~1.9	0.69~2.36	1.39~3.61	2.22~6.39	2.8~7.8
Maximum pressure [bar]	23	22	21	24	23	23	23
Power [kW]	0.37~3	0.37~3	0.37~4	0.37~5.5	0.75~7.5	1.1~15	1.1~18.5
Temperature range [°C]	-15~105						
Highest efficiency [%]	46	50	58	63	70	73	69
Pipe Connection							
DIN flange	DN 32/25	DN 32/25	DN32	DN32	DN40	DN50	DN50
Thread	R ₁ 1 1/4"	R ₁ 1 1/4"	R ₁ 1 1/4"	R ₁ 1 1/4"	R ₁ 2"	R ₁ 2"	R ₁ 2"
Clamp connection	DN32	DN32	DN32	DN32	DN50	DN50	DN50

Parameter	KMC 32	KMC 45	KMC 64	KMC 90	KMC 120	KMC150	KMC 200
Rated flow rate [m ³ /h]	32	45	64	90	120	150	200
Rated flow rate [l/s]	8.9	12.5	17.8	25	33.3	41.7	55.6
Flow rate [m ³ /h]	16~40	25~55	30~80	50~110	60~150	80~180	100~240
Flow rate [l/s]	4.4~11	6.9~15.3	8~22	14~30	17~42	22~50	28~67
Maximum pressure [bar]	26	30	22	17	16	16	16
Power [kW]	1.5~30	3~45	4~45	5.5~45	11~75	11~75	18.5~110
Temperature range [°C]	-15~105						
Highest efficiency [%]	74	75	76	77	74	73	79
KMC Pipe Connection							
DIN flange	DN65	DN80	DN100	DN100	DN125	DN125	DN150

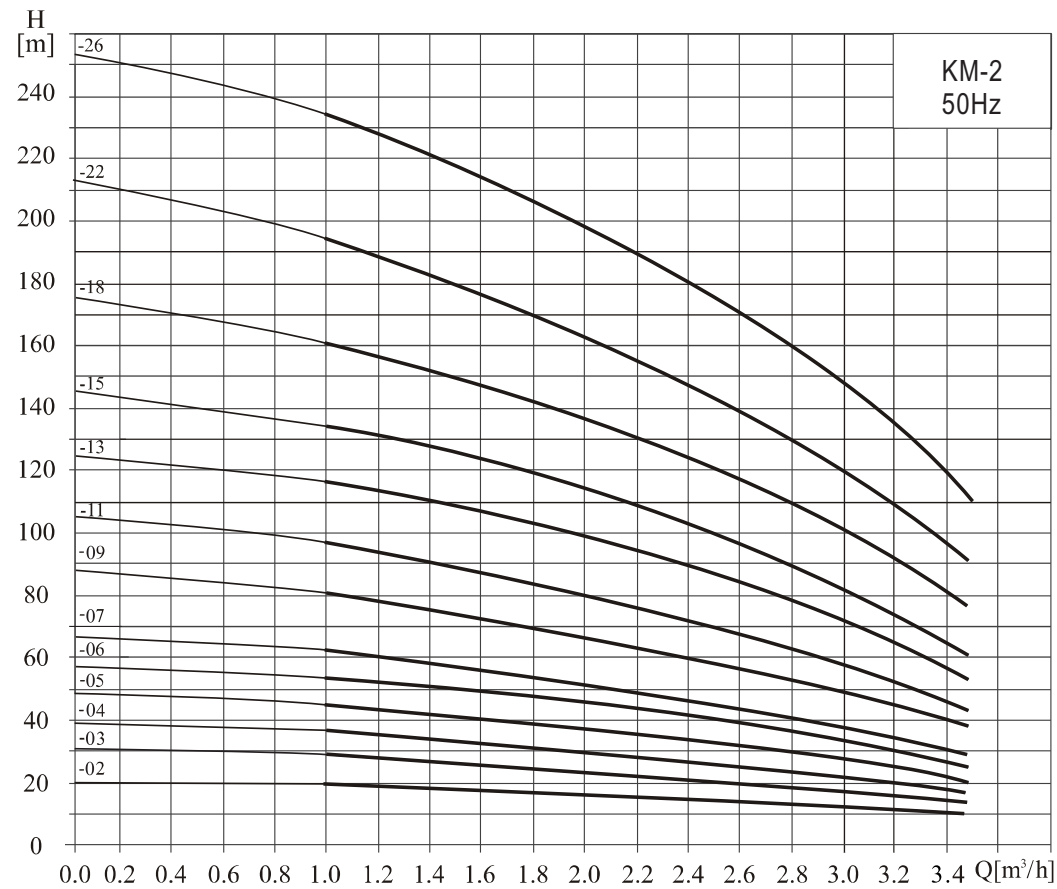

Performance Table

2900 rpm

Model	Power		Q (m³/h)	H (m)								
	kW	HP		1	1.2	1.6	2.0	2.4	2.8	3.2	3.5	
KMC-2/02	0.37	0.5	18	17	16	15	13	12	10	8		
KMC-2/03	0.37	0.5	27	26	24	22	20	18	15	12		
KMC-2/04	0.55	0.75	36	35	33	30	26	24	20	16		
KMC-2/05	0.55	0.75	45	43	40	37	33	30	24	20		
KMC-2/06	0.75	1	53	52	50	45	40	36	30	24		
KMC-2/07	0.75	1	63	61	57	52	47	41	35	28		
KMC-2/09	1.1	1.5	80	78	73	67	61	54	45	37		
KMC-2/11	1.1	1.5	98	95	89	82	73	64	54	44		
KMC-2/13	1.5	2	116	114	106	98	89	78	65	52		
KMC-2/15	1.5	2	116	130	123	112	100	90	73	60		
KMC-2/18	2.2	3	136	157	148	136	121	108	91	76		
KMC-2/22	2.2	3	197	192	180	165	148	130	110	90		
KMC-2/26	3	4	232	228	214	198	179	158	130	110		

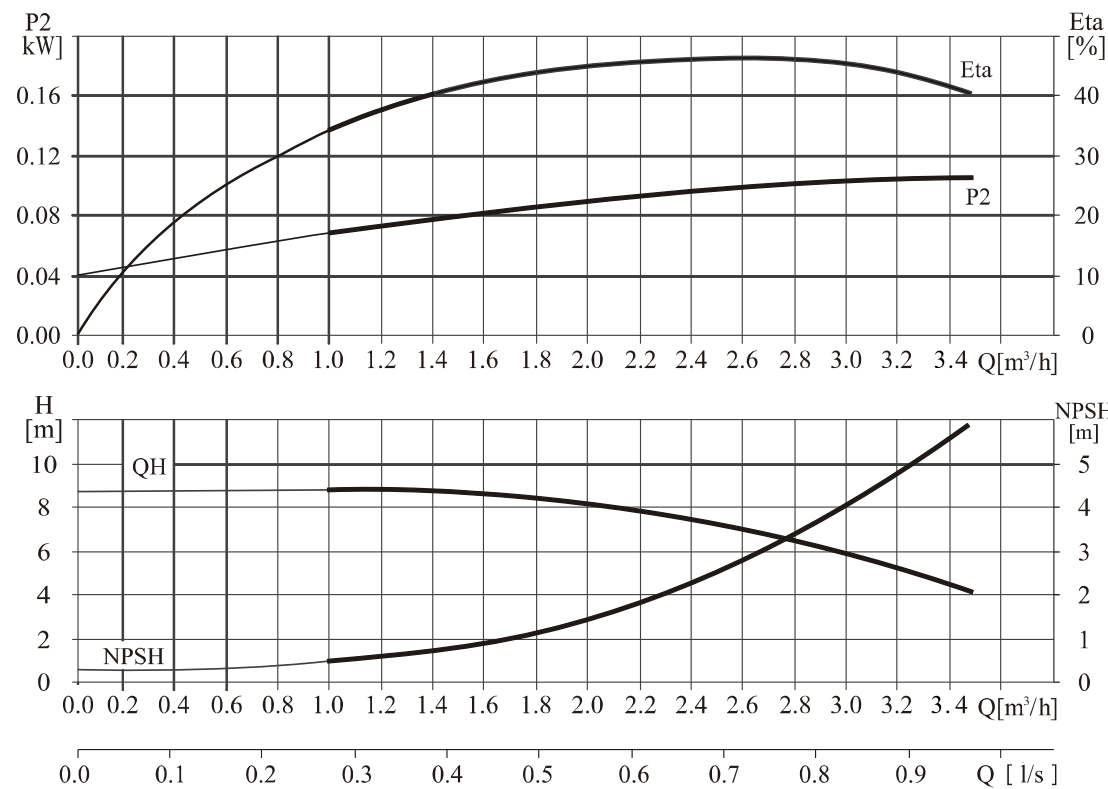

Dimension & Weight Details

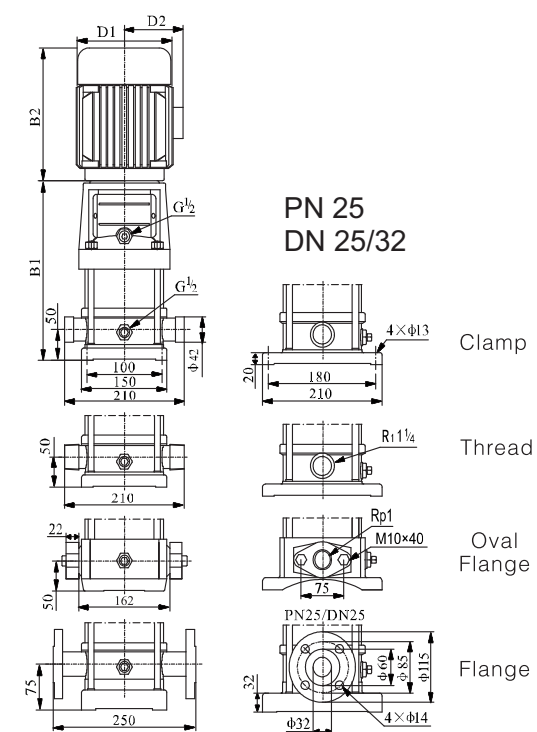

Model	Dimensions (mm)					Weight (kg)
	B1	B2	B1+B2	D1	D2	
KMC-2/02	258	239	497	148	117	20
KMC-2/03	276	239	515	148	117	20
KMC-2/04	294	239	533	148	117	22
KMC-2/05	312	239	551	148	177	23
KMC-2/06	340	280	620	170	142	26
KMC-2/07	358	280	638	170	142	26
KMC-2/09	394	280	674	170	142	28
KMC-2/11	430	280	710	170	142	29
KMC-2/13	476	333	809	190	155	35
KMC-2/15	512	333	845	190	155	36
KMC-2/18	566	333	899	190	155	41
KMC-2/22	638	333	971	190	155	42
KMC-2/26	720	348	1068	197	165	52

In view of continuous improvements in our design and process, the information, dimensions and specifications given herein are subject to change without notice.

Replace 3rd digit in model name as 'S' for SS 304 Pump housing & Pump Cover and 'N' for SS316 Pump housing & Pump Cover. Suffix 'S' for single phase & 'T' for three phase motor. By Default Pump will be supplied with round flange connection.

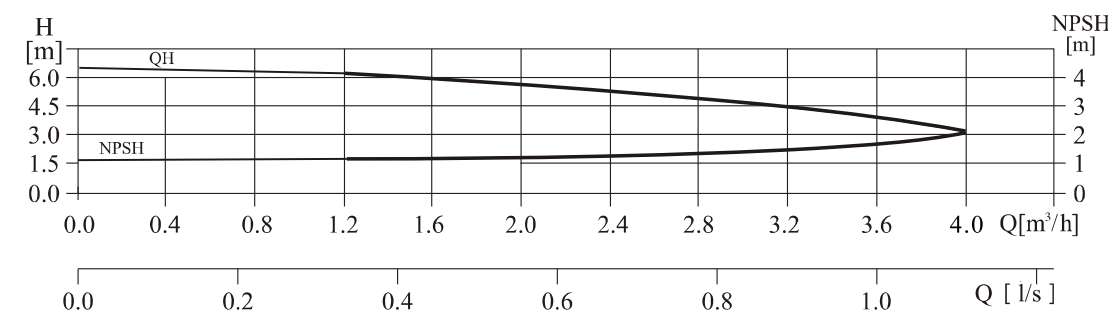
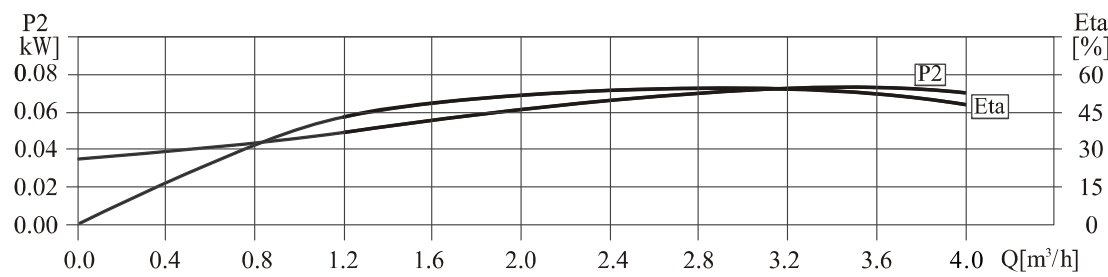
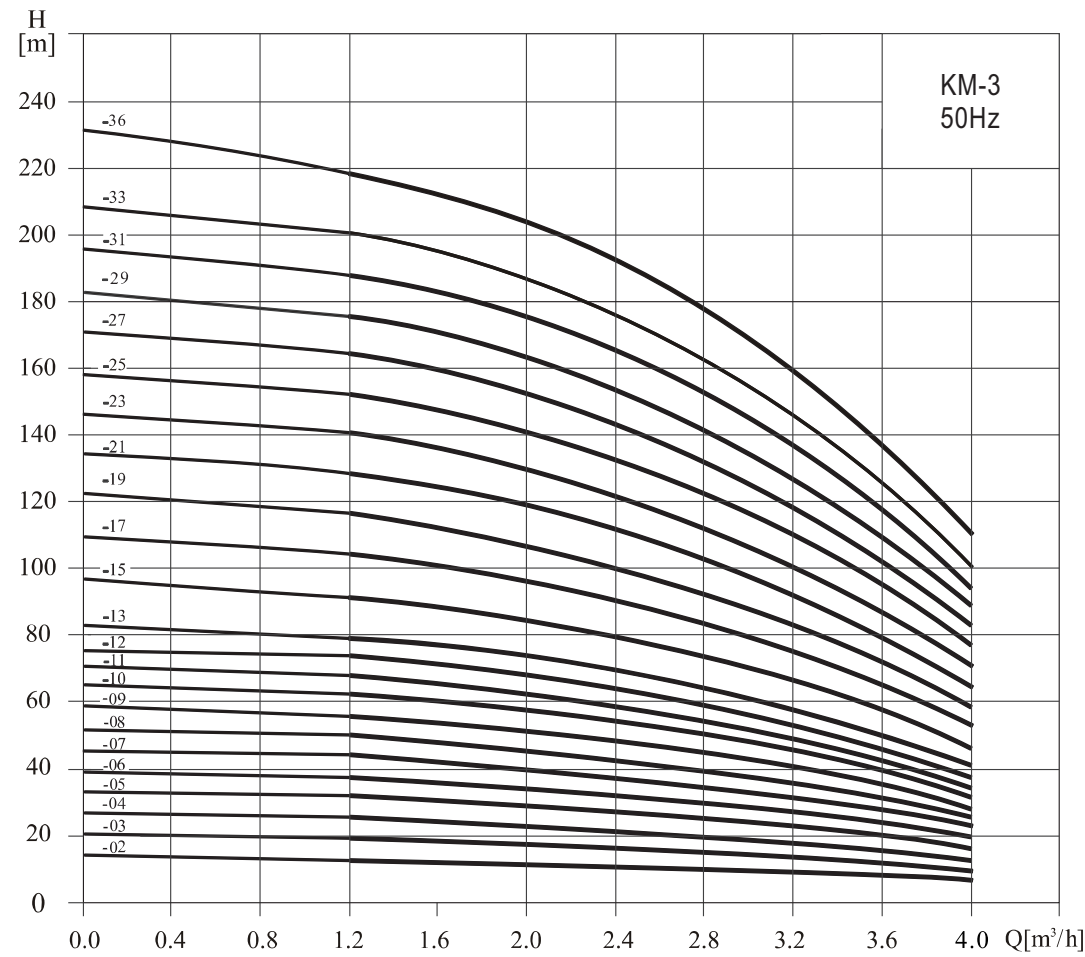

Performance Table

2900 rpm

Model	Power		Q (m³/h)	H (m)										
	kW	HP		1.2	1.6	2.0	2.4	2.8	3.0	3.2	3.6	4.0		
KMC-3/02	0.37	0.5	12.5	11.5	11	10.5	10	9	8	7	6			
KMC-3/03	0.37	0.5	19	18.5	17.5	16.5	15	14	13	11	9			
KMC-3/04	0.37	0.5	25	24	23	21.5	20	19	18	15	12			
KMC-3/05	0.37	0.5	31	30	29	27	25	23	22	19	16			
KMC-3/06	0.55	0.75	36	35	34	32	30	28	27	23	19			
KMC-3/07	0.55	0.75	43	41	39	37	34	32	31	27	22			
KMC-3/08	0.75	1	49	47	45	43.2	39	37	32	31	25			
KMC-3/09	0.75	1	55	53	51	48	45	42	40	35	28			
KMC-3/10	0.75	1	61	59	57	54	50	47	45	39	31			
KMC-3/11	1.1	1.5	67	64	61	58	54	51	49	42	34			
KMC-3/12	1.1	1.5	73	70	67	63	58	55	52	45	37			
KMC-3/13	1.1	1.5	78	76	73	69	64	60	57	49	40			
KMC-3/15	1.1	1.5	90	88	84	79	73	69	66	57	46			
KMC-3/17	1.5	2	103	100	96	90	83	79	75	64	52			
KMC-3/19	1.5	2	115	112	107	100	92	88	83	72	58			
KMC-3/21	2.2	3	128	124	119	112	102	98	91	79	64			
KMC-3/23	2.2	3	140	135	130	122	112	107	100	86	70			
KMC-3/25	2.2	3	151	147	141	131	122	116	109	94	76			
KMC-3/27	2.2	3	164	159	152	143	132	124	117	101	82			
KMC-3/29	2.2	3	175	170	163	153	142	133	126	109	88			
KMC-3/31	3.0	4	187	182	175	165	153	142	135	116	94			
KMC-3/33	3.0	4	199	194	187	176	163	151	145	125	100			
KMC-3/36	3.0	4	218	212	204	192	178	168	159	137	109			

Dimensions & Weight Details

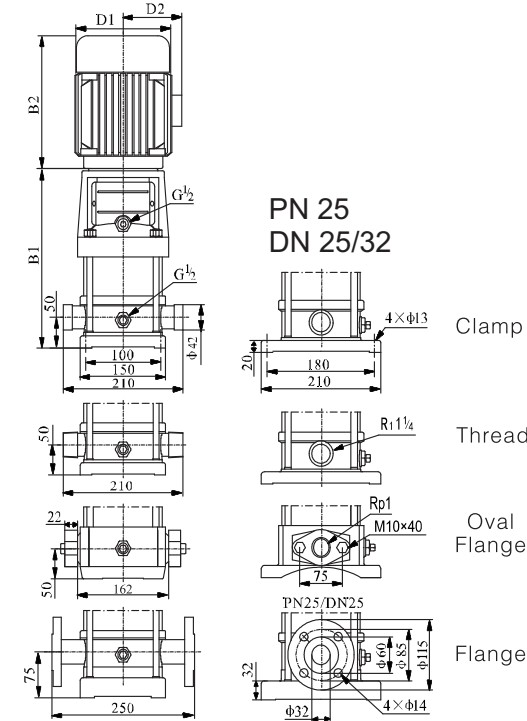

Model	Dimensions (mm)					Weight (kg)
	B1	B2	B1+B2	D1	D2	
KMC-3/02	258	239	497	148	117	20
KMC-3/03	276	239	515	148	177	20
KMC-3/04	294	239	533	148	177	21
KMC-3/05	312	239	551	148	177	21
KMC-3/06	330	239	569	148	177	23
KMC-3/07	348	239	587	148	177	24
KMC-3/08	376	280	656	170	142	27
KMC-3/09	394	280	674	170	142	28
KMC-3/10	412	280	692	170	142	28
KMC-3/11	430	280	710	170	142	29
KMC-3/12	448	280	728	170	142	30
KMC-3/13	466	280	746	170	142	31
KMC-3/15	502	280	782	170	142	32
KMC-3/17	548	333	881	190	155	38
KMC-3/19	584	333	917	190	155	39
KMC-3/21	620	333	953	190	155	42
KMC-3/23	656	333	989	190	155	43
KMC-3/25	692	333	1025	190	155	44
KMC-3/27	728	333	1061	190	155	45
KMC-3/29	764	333	1097	190	155	46
KMC-3/31	810	348	1058	197	165	54
KMC-3/33	846	348	1194	197	165	55
KMC-3/36	900	348	1248	197	165	57

In view of continuous improvements in our design and process, the information, dimensions and specifications given herein are subject to change without notice.

Replace 3rd digit in model name as 'S' for SS 304 Pump housing & Pump Cover and 'N' for SS316 Pump housing & Pump Cover. Suffix 'S' for single phase & 'T' for three phase motor. By Default Pump will be supplied with round flange connection.

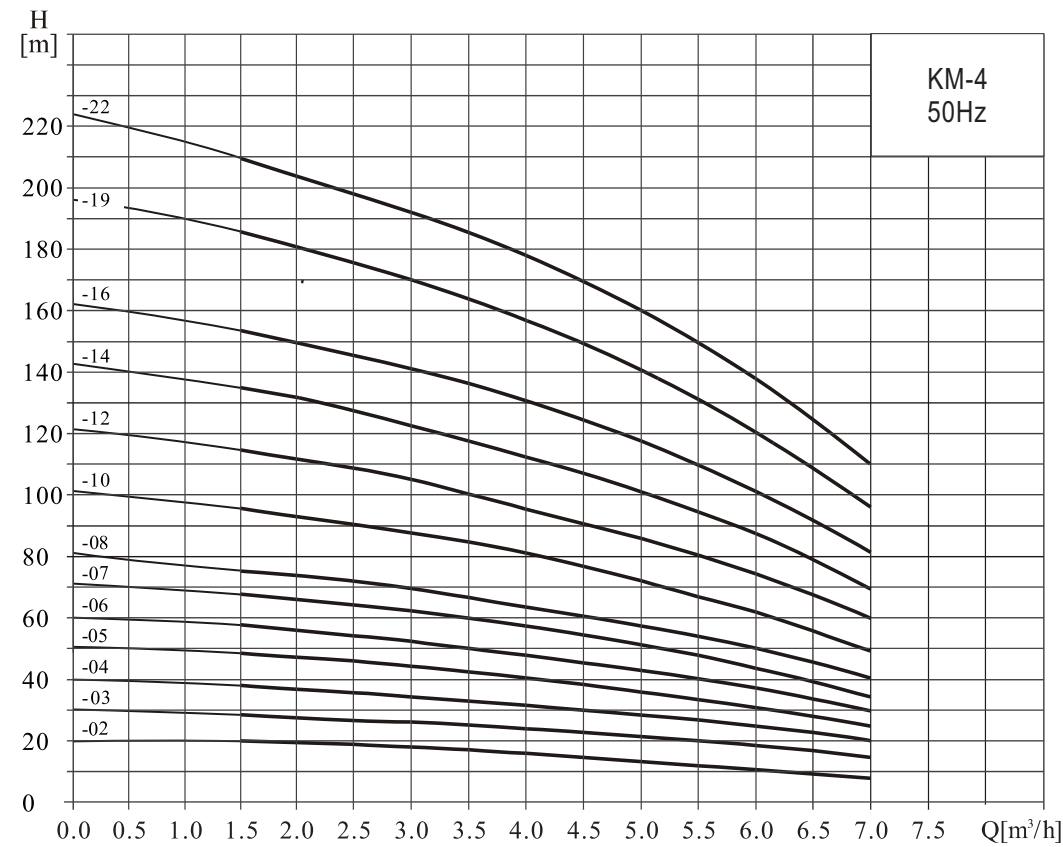

Performance Table

2900 rpm

Model	Power		Q (m³/h)	1.5	2.0	3.0	4.0	5.0	6.0	7.0
	kW	HP								
KMC-4/02	0.37	0.5	H (m)	19	18	17	15	13	10	8
KMC-4/03	0.55	0.75		28	27	26	24	20	18	13
KMC-4/04	0.75	1		38	36	34	32	27	24	19
KMC-4/05	1.1	1.5		47	45	43	40	34	31	23
KMC-4/06	1.1	1.5		56	54	52	48	41	37	28
KMC-4/07	1.5	2		66	63	61	56	48	43	33
KMC-4/08	1.5	2		76	72	70	64	55	50	38
KMC-4/10	2.2	3		96	90	87	81	71	62	48
KMC-4/12	2.2	3		144	108	104	95	85	75	58
KMC-4/14	3.0	4		136	126	122	112	101	89	68
KMC-4/16	3.0	4		152	144	140	129	115	101	78
KMC-4/19	4.0	5.5		183	171	168	153	137	122	93
KMC-4/22	4.0	5.5		211	200	192	178	160	138	108

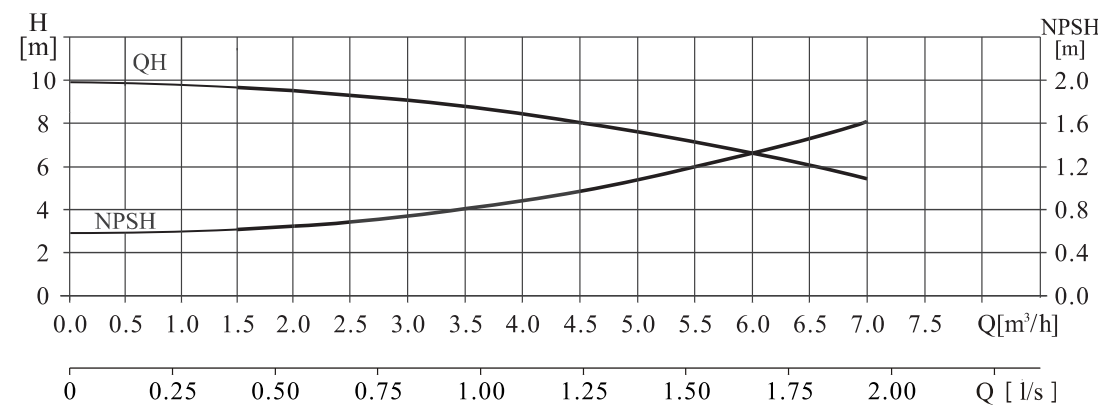
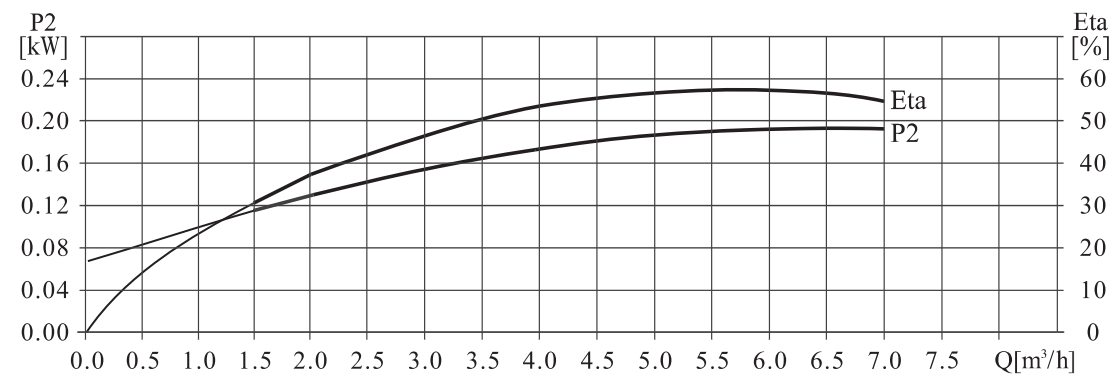

Dimension & Weight Details

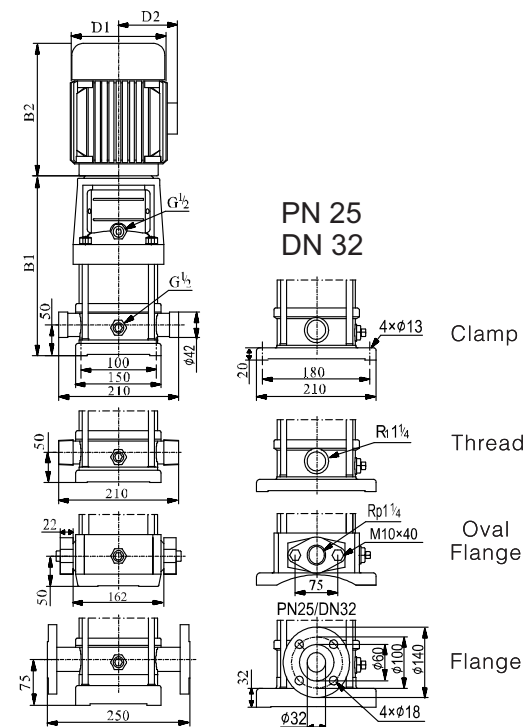

Model	Dimensions (mm)					Weight (kg)
	B1	B2	B1+B2	D1	D2	
KMC-4/02	276	239	515	148	117	21
KMC-4/03	303	239	542	148	117	22
KMC-4/04	340	280	620	170	142	25
KMC-4/05	367	280	647	170	142	27
KMC-4/06	394	280	674	170	142	27
KMC-4/07	413	333	764	190	155	33
KMC-4/08	458	333	791	190	155	33
KMC-4/10	512	333	845	190	155	37
KMC-4/12	566	333	899	190	155	38
KMC-4/14	630	348	978	197	165	46
KMC-4/16	684	348	1032	197	165	48
KMC-4/19	765	382	1147	230	188	57
KMC-4/22	846	382	1228	230	188	59

In view of continuous improvements in our design and process, the information, dimensions and specifications given herein are subject to change without notice.

Replace 3rd digit in model name as 'S' for SS 304 Pump housing & Pump Cover and 'N' for SS316 Pump housing & Pump Cover. Suffix 'S' for single phase & 'T' for three phase motor. By Default Pump will be supplied with round flange connection.

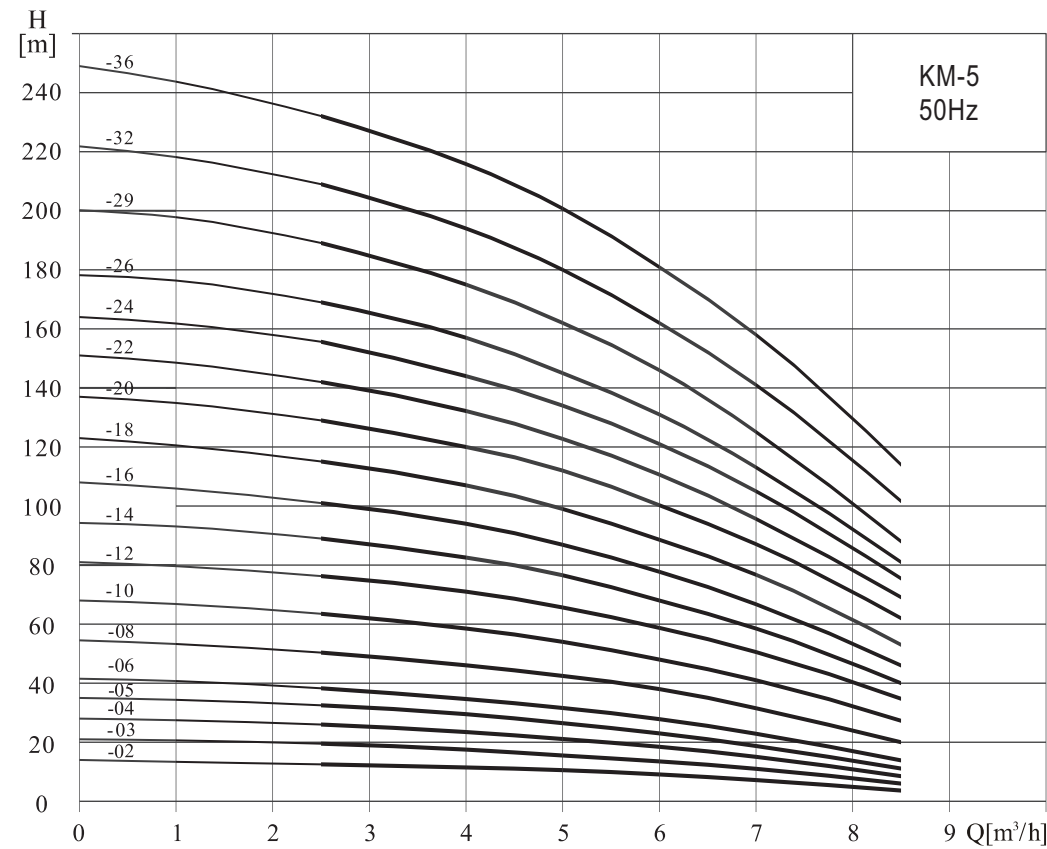

Performance Table

2900 rpm

Model	Power		Q (m³/h)	2.5	4	5	6	7	8.5
	kW	HP							
KMC-5/02	0.37	0.5		12.5	11.5	10.5	9	7	3.5
KMC-5/03	0.55	0.75		19.5	17.5	15.5	13.5	11	6
KMC-5/04	0.55	0.75		26	23.5	21	18.5	15	8.5
KMC-5/05	0.75	1		32.5	29.5	26.5	23	18.5	11
KMC-5/06	1.1	1.5		38.5	34.5	31.5	28	23	14
KMC-5/08	1.1	1.5		50.5	46	42.5	38	31.5	20
KMC-5/10	1.5	2		63.5	58.5	54	48	41	27.5
KMC-5/12	2.2	3		76	71	65.5	58.5	50.5	35
KMC-5/14	2.2	3		89	82	76.5	68	58.5	40
KMC-5/16	2.2	3		101	94	87	77.5	66.5	46
KMC-5/18	3.0	4		115	107	99	88.5	77	53
KMC-5/20	3.0	4		129	120	112	100	87	62
KMC-5/22	4.0	5.5		142	132	123	111	96	69
KMC-5/24	4.0	5.5		156	144	132	121	105	75.5
KMC-5/26	4.0	5.5		169	157	145	131	113	81
KMC-5/29	4.0	5.5		189	175	162	146	125	88
KMC-5/32	5.5	7.5		209	194	180	162	141	102
KMC-5/36	5.5	7.5		232	216	201	181	158	114

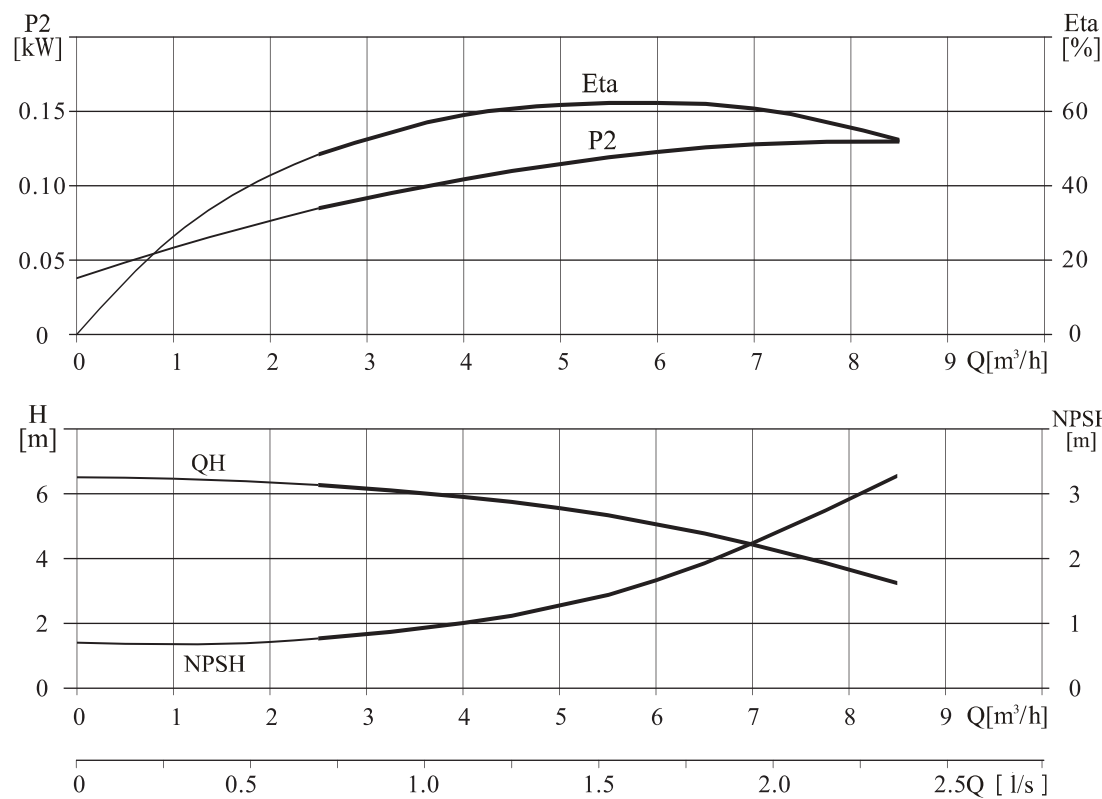

Dimension & Weight Details

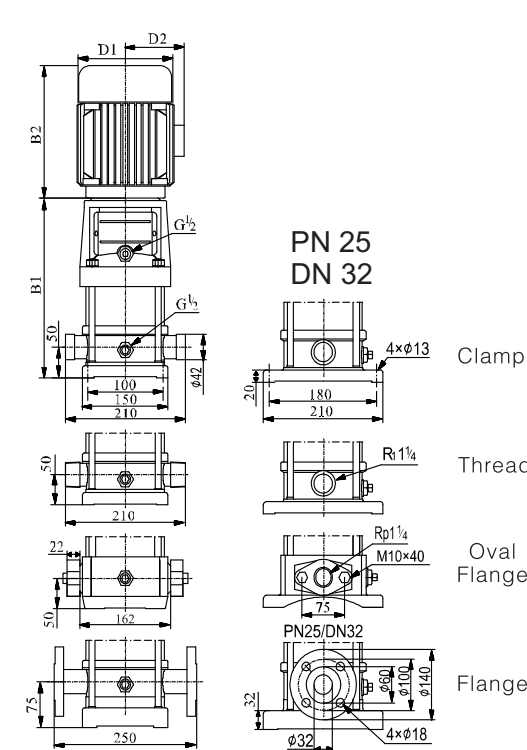

Model	Dimensions (mm)					Weight (kg)
	B1	B2	B1+B2	D1	D2	
KMC-5/02	276	239	515	148	117	21
KMC-5/03	303	239	541	148	177	22
KMC-5/04	330	239	569	148	117	23
KMC-5/05	367	280	647	170	142	25
KMC-5/06	394	280	674	170	142	26
KMC-5/08	448	280	628	170	142	27
KMC-5/10	512	333	845	190	155	33
KMC-5/12	566	333	899	190	155	37
KMC-5/14	620	333	953	190	155	38
KMC-5/16	674	333	1007	190	155	39
KMC-5/18	738	348	1086	197	165	48
KMC-5/20	792	348	1140	197	165	49
KMC-5/22	846	382	1228	230	185	57
KMC-5/24	900	382	1282	230	185	58
KMC-5/26	954	382	1336	230	185	59
KMC-5/29	1035	382	1417	230	185	60
KMC-5/32	1136	435	1571	260	210	75
KMC-5/36	1244	435	1679	260	210	76

In view of continuous improvements in our design and process, the information, dimensions and specifications given herein are subject to change without notice.

Replace 3rd digit in model name as 'S' for SS 304 Pump housing & Pump Cover and 'N' for SS316 Pump housing & Pump Cover. Suffix 'S' for single phase & 'T' for three phase motor. By Default Pump will be supplied with round flange connection.

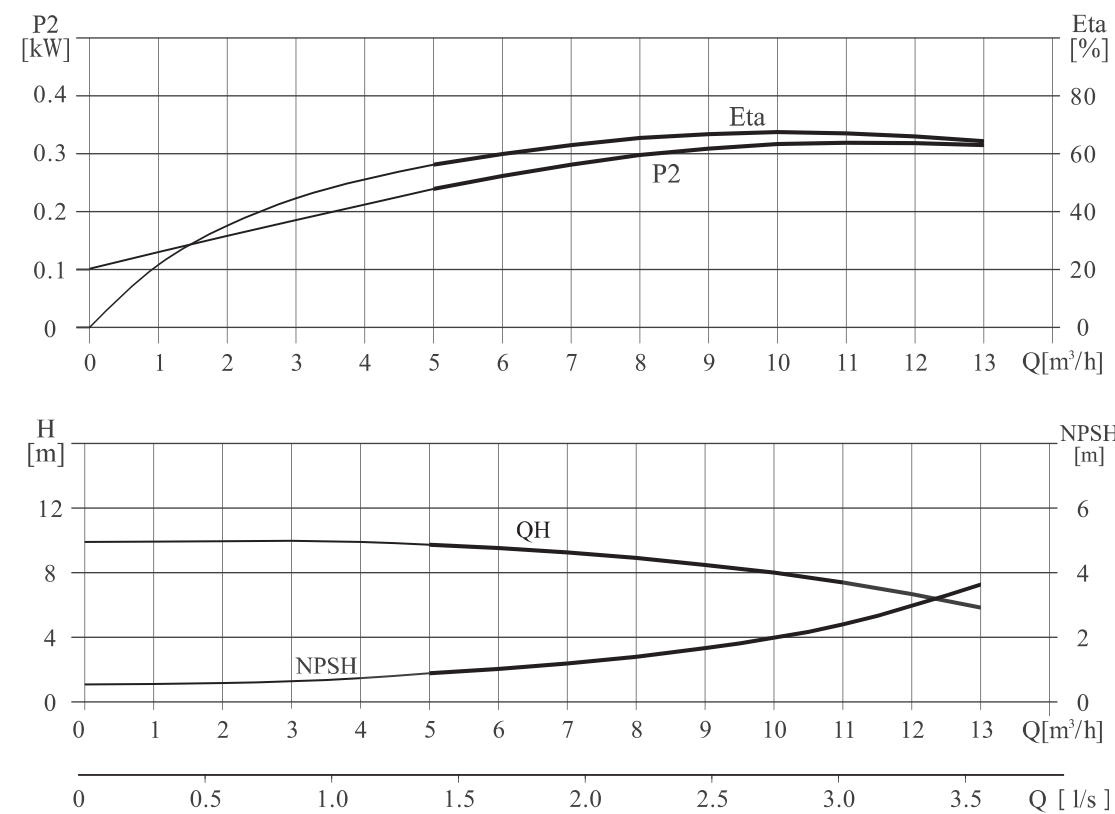
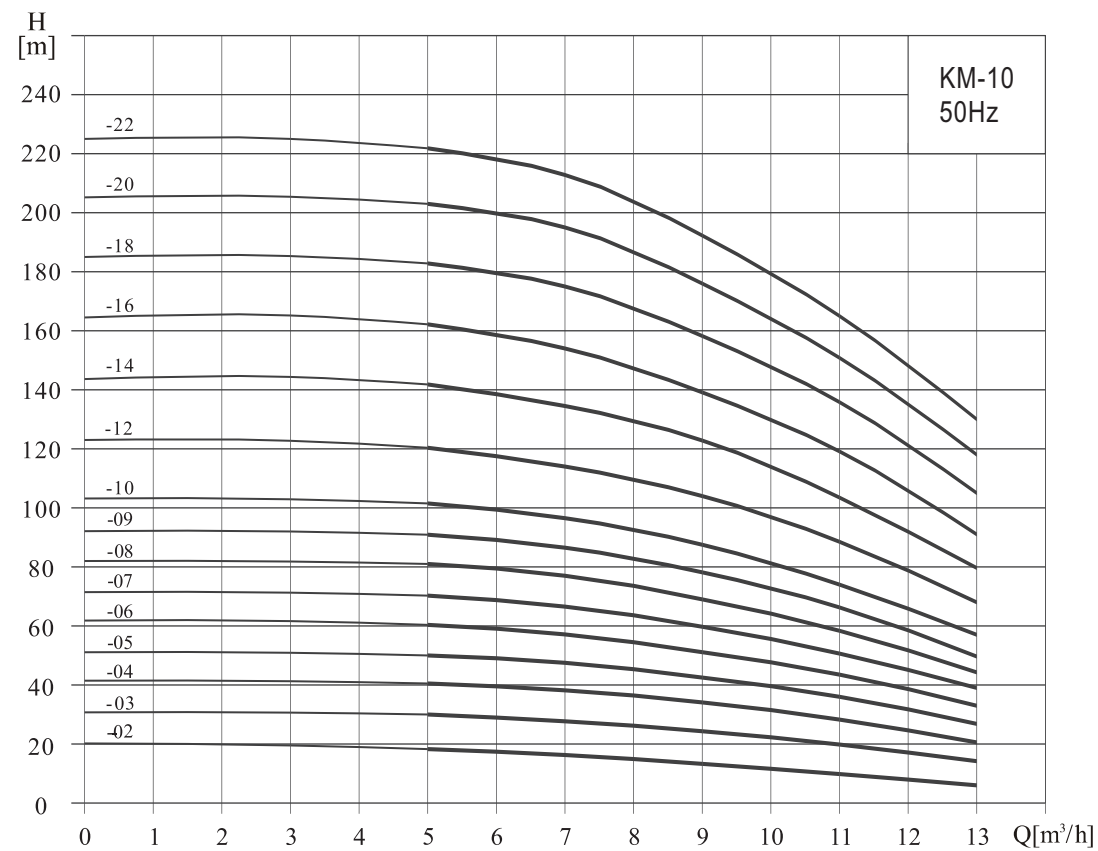

Performance Table

2900 rpm

Model	Power		Q (m³/h)	H (m)										
	kW	HP		5	6	7	8	9	10	11	12	13		
KMC-10/02	0.75	1	18.5	17	16	14	13	12	10	8.5	7			
KMC-10/03	1.1	1.5	30	28.5	27.5	25.5	24.5	22	20	18	14.5			
KMC-10/04	1.5	2	40.5	39.5	38.5	36.5	34	31.5	28.5	25.5	21			
KMC-10/05	2.2	3	50	49	47.5	45.5	42.5	39.5	36	32	27			
KMC-10/06	2.2	3	60	59	57	55	51	47.5	43.5	39	33.5			
KMC-10/07	3.0	4	70.5	69	66.5	64	59.5	55.5	50.5	45.5	39			
KMC-10/08	3.0	4	81	79	77	74.5	69	64	58.5	53	44.5			
KMC-10/09	3.0	4	91	89	86.5	82.5	78	72	66.5	59.5	50			
KMC-10/10	4.0	5.5	101.5	99	96.5	92.5	87.5	81.5	74	67	57			
KMC-10/12	4.0	5.5	120.5	119	114	110	104	97	88.5	80	68			
KMC-10/14	5.5	7.5	142	139	134.5	131	123	114	103.5	93.5	80			
KMC-10/16	5.5	7.5	162	159	154	148.5	139	130	119	107	91			
KMC-10/18	7.5	10	183	180	175	167	158	148	136	121	105			
KMC-10/20	7.5	10	203	200	195	186	176	165	151	134	118			
KMC-10/22	7.5	10	222	219	213	203	192	179	165	149	130			

Dimension & Weight Details

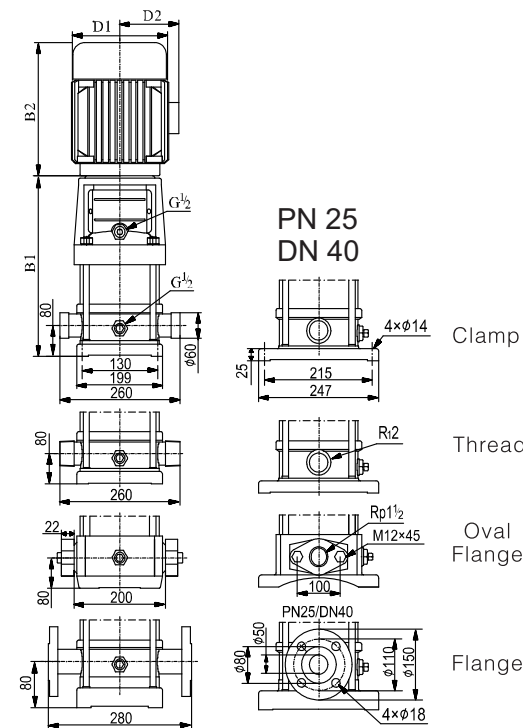

Model	Dimensions (mm)					Weight (kg)
	B1	B2	B1+B2	D1	D2	
KMC-10/02	347	280	627	170	142	32
KMC-10/03	377	280	657	170	142	34
KMC-10/04	417	333	750	190	155	40
KMC-10/05	447	333	780	190	155	44
KMC-10/06	477	333	810	197	165	45
KMC-10/07	517	348	865	197	165	52
KMC-10/08	547	348	895	197	165	53
KMC-10/09	577	348	925	197	165	54
KMC-10/10	607	382	989	230	185	64
KMC-10/12	667	382	1049	230	185	66
KMC-10/14	747	435	1182	260	210	81
KMC-10/16	807	435	1242	260	210	82
KMC-10/18	867	435	1302	260	210	93
KMC-10/20	927	435	1362	260	210	94
KMC-10/22	987	435	1422	260	210	95

In view of continuous improvements in our design and process, the information, dimensions and specifications given herein are subject to change without notice.

Replace 3rd digit in model name as 'S' for SS 304 Pump housing & Pump Cover and 'N' for SS316 Pump housing & Pump Cover. Suffix 'S' for single phase & 'T' for three phase motor. By Default Pump will be supplied with round flange connection.

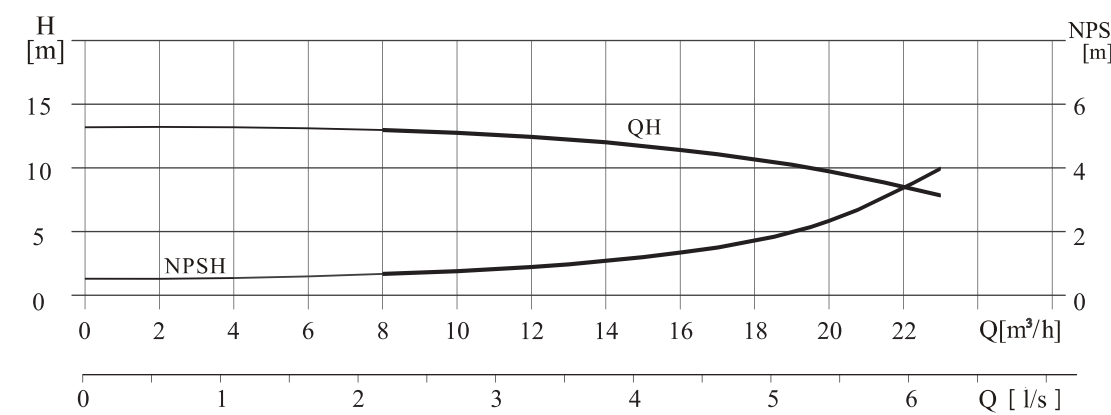
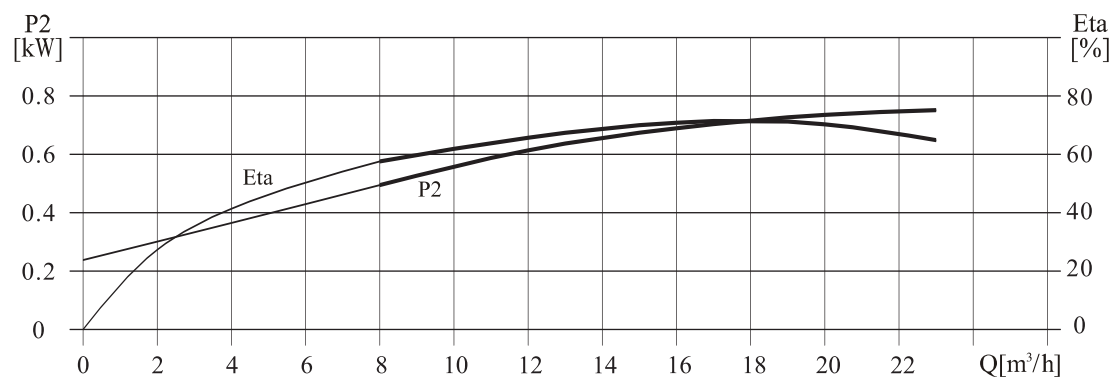
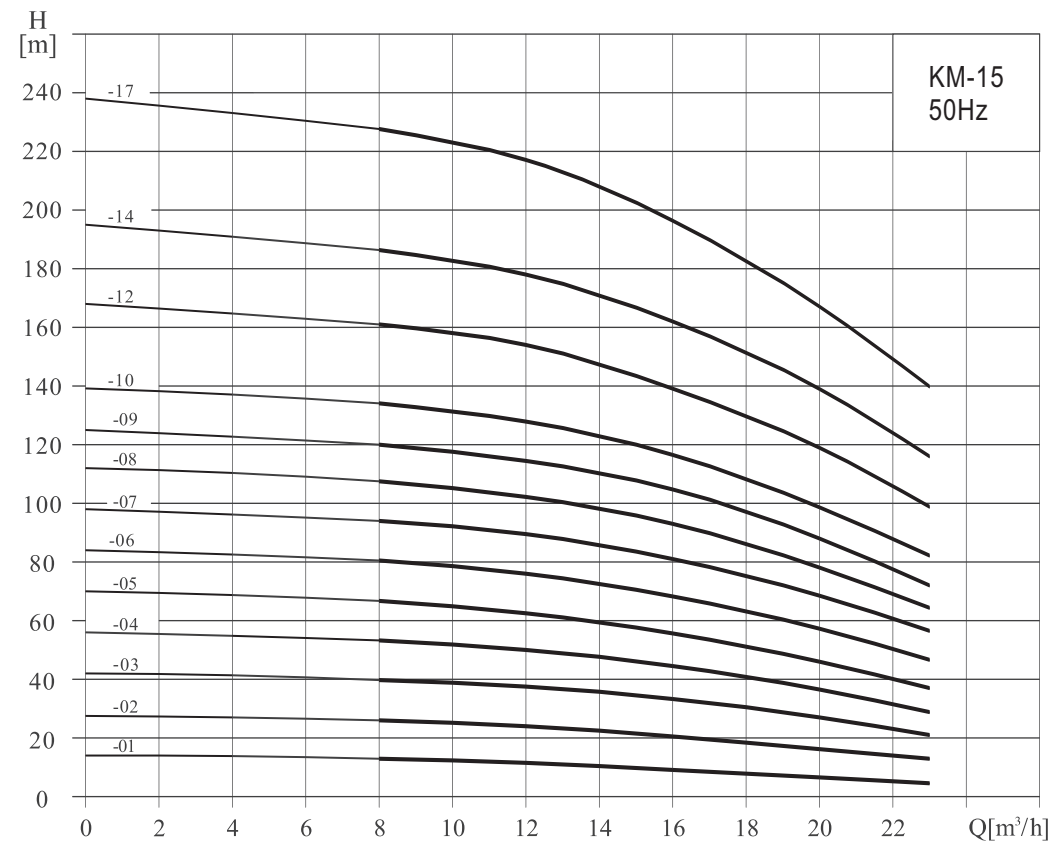

In view of continuous improvements in our design and process, the information, dimensions and specifications given herein are subject to change without notice.

Performance Table

2900 rpm

Model	Power		Q (m³/h)	H (m)										
	kW	HP		8	10	12	14	15	16	18	20	23		
KMC-15/01	1.1	1.5	13	12	11.5	10.5	10	9	7.5	6	4.5			
KMC-15/02	2.2	3	26	25	24	23	22	20.5	18	16	13			
KMC-15/03	3.0	4	39.5	38.5	37.5	35.5	34.5	33.5	30.5	27	21			
KMC-15/04	4.0	5.5	53	51	50	47.5	46	44.5	41	36.5	29			
KMC-15/05	4.0	5.5	67	64	62.5	60	58	55.5	52	46	37			
KMC-15/06	5.5	7.5	80.5	78	76	73	70.5	68	63.5	57	46.5			
KMC-15/07	5.5	7.5	94	92	89.5	86	83.5	81	75.5	68.5	56.5			
KMC-15/08	7.5	10	107.5	106	102.5	98.5	96	93	86.5	78	64.5			
KMC-15/09	7.5	10	120	118	114.5	110	107	105	97	88	72			
KMC-15/10	11	15	134	132	128	123	120	116.5	108.5	98.5	82.5			
KMC-15/12	11	15	161	158	154	148	144	139	130	119	99			
KMC-15/14	11	15	186	183	178	172	167	162	152	139	116			
KMC-15/17	15	20	227	224	217	210	203	196	182	167	140			

Dimension & Weight Details

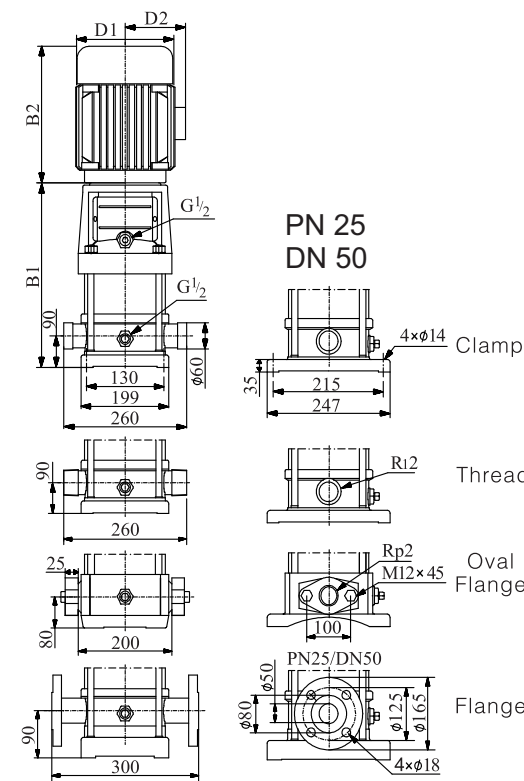

Model	Dimensions (mm)					Weight (kg)
	B1	B2	B1+B2	D1	D2	
KMC-15/01	352	280	632	170	142	33
KMC-15/02	397	333	730	190	155	42
KMC-15/03	452	348	800	197	165	50
KMC-15/04	497	382	879	230	185	59
KMC-15/05	542	382	924	230	185	60
KMC-15/06	607	382	1042	260	210	77
KMC-15/07	652	435	1087	260	210	78
KMC-15/08	697	435	1132	260	210	86
KMC-15/09	742	435	1177	260	210	87
KMC-15/10	875	435	1455	250	260	160
KMC-15/12	965	580	1545	350	260	161
KMC-15/14	1055	580	1635	350	260	162
KMC-15/17	1190	580	1770	350	260	179

Replace 3rd digit in model name as 'S' for SS 304 Pump housing & Pump Cover and 'N' for SS316 Pump housing & Pump Cover. Suffix 'S' for single ph
By Default Pump will be supplied with round flange connection.

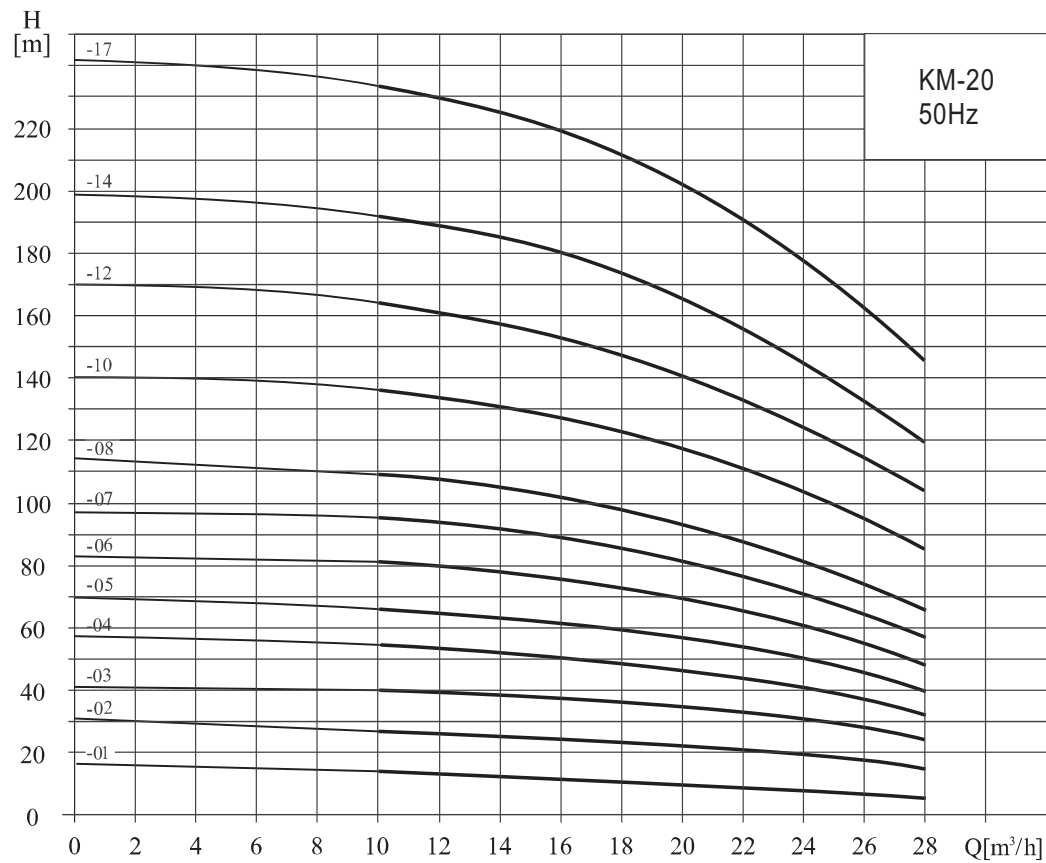

Performance Table

2900 rpm

Model	Power		Q (m³/h)	H (m)											
	kW	HP		10	12	14	16	18	20	22	24	26	28		
KMC-20/01	1.1	1.5		13.5	13	12.5	12	11	10	9	8	7	6		
KMC-20/02	2.2	3		27	26.5	26	25	24	23	22	20	18	15		
KMC-20/03	4.0	5.5		40	39.5	39	38	37	35	33	30	27	24		
KMC-20/04	5.5	7.5		54	53	52	51	49	47	44	41	37	33		
KMC-20/05	5.5	7.5		67	65	64	62	60	58	55	50	45	40		
KMC-20/06	7.5	10		81	79	77	75	73	70	66	61	55	49		
KMC-20/07	7.5	10		95	93	91	89	86	82	77	71	65	58		
KMC-20/08	11	15		109	107	105	102	99	94	89	82	75	67		
KMC-20/10	11	15		136	134	131	128	124	118	111	103	95	85		
KMC-20/12	15	20		164	162	158	154	149	142	133	124	114	102		
KMC-20/14	15	20		192	189	185	180	174	166	156	145	133	119		
KMC-20/17	18.5	25		234	230	225	219	212	202	190	177	162	145		

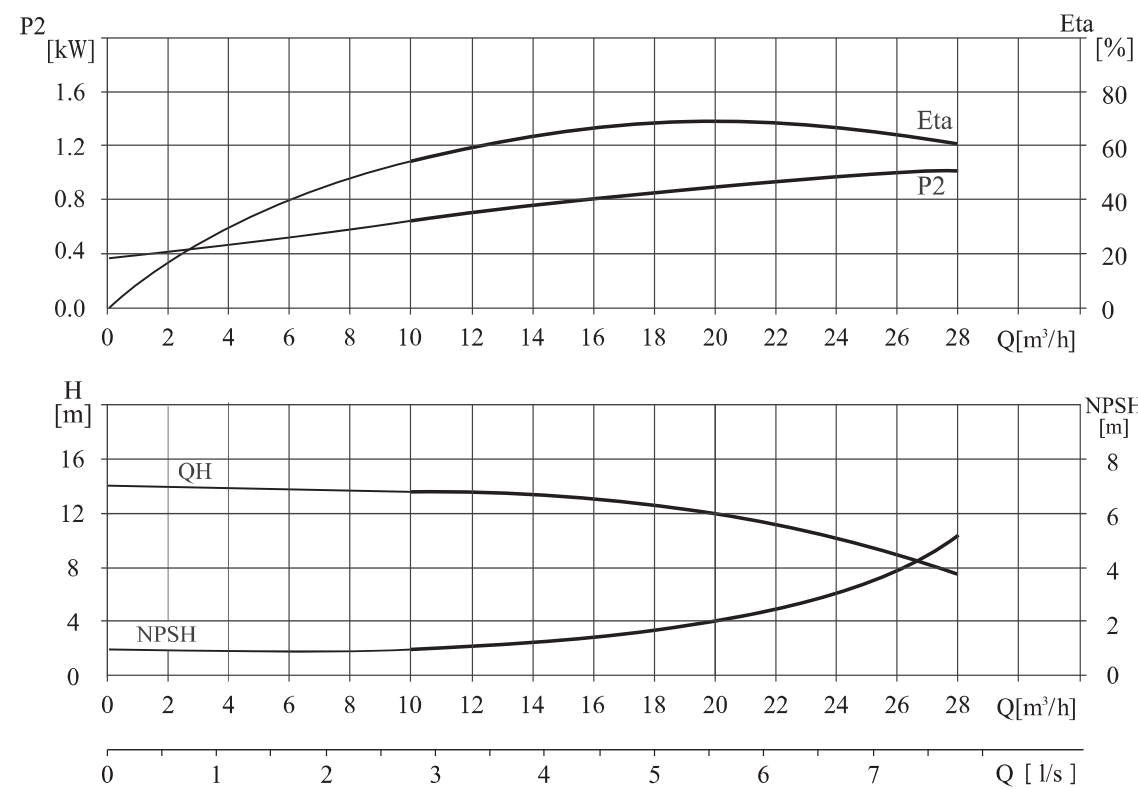

Dimension & Weight Details

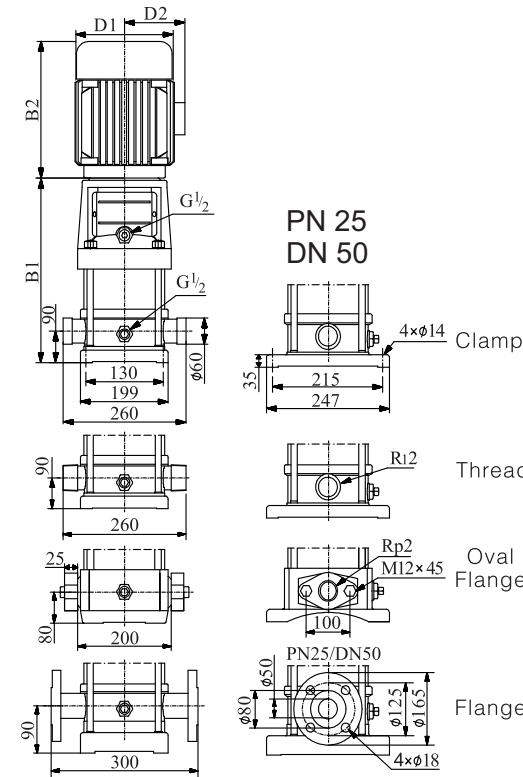

Model	Dimensions (mm)					Weight (kg)
	B1	B2	B1+B2	D1	D2	
KMC-20/01	387	280	667	170	142	33
KMC-20/02	397	333	730	190	155	42
KMC-20/03	452	382	834	230	188	58
KMC-20/04	517	435	952	260	208	74
KMC-20/05	562	435	997	260	208	76
KMC-20/06	607	435	1042	260	208	82
KMC-20/07	652	435	1087	260	208	84
KMC-20/08	785	580	1365	350	260	153
KMC-20/10	875	580	1455	350	260	157
KMC-20/12	965	580	1545	350	260	170
KMC-20/14	1055	580	1635	350	260	172
KMC-20/17	1190	610	1800	350	260	195

In view of continuous improvements in our design and process, the information, dimensions and specifications given herein are subject to change without notice.

Replace 3rd digit in model name as 'S' for SS 304 Pump housing & Pump Cover and 'N' for SS316 Pump housing & Pump Cover. Suffix 'S' for single phase & 'T' for three phase motor. By Default Pump will be supplied with round flange connection.

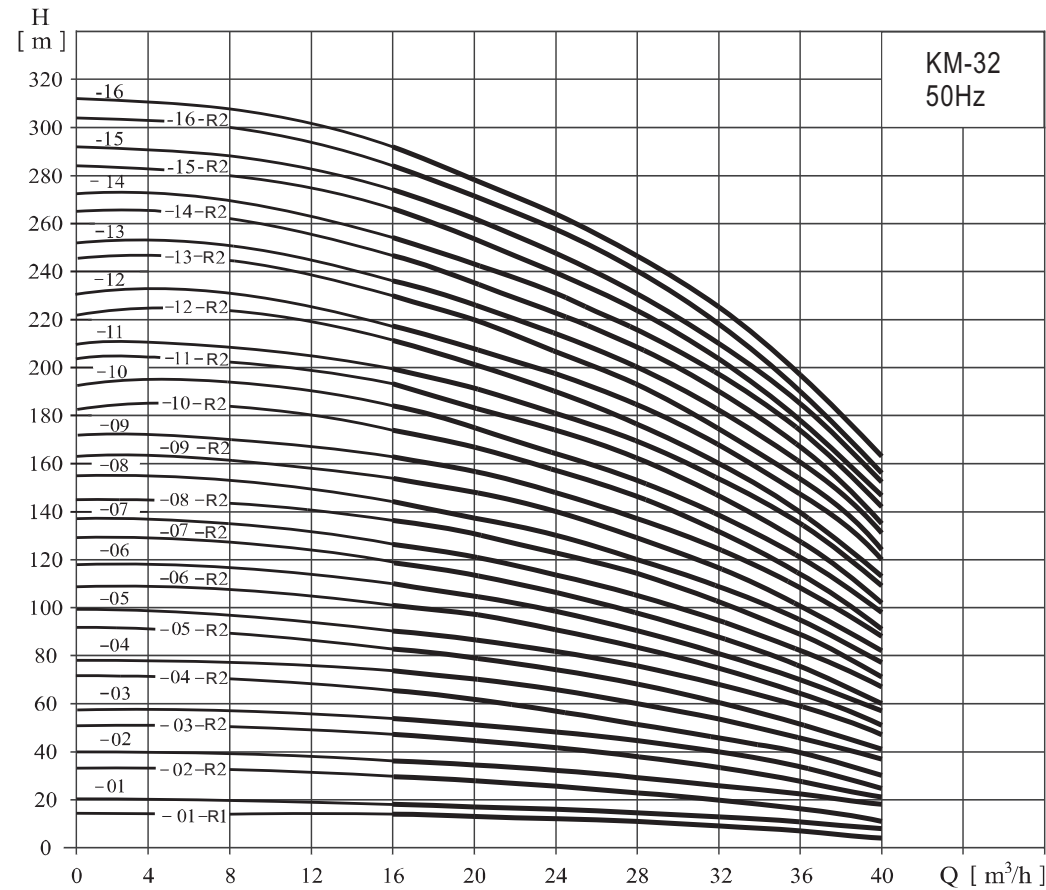

Performance Table

Model	Power		Q (m³/h)	2900 rpm															
	kW	HP		16	20	24	28	32	36	40									
KMC-32/01-R1	1.5	2	14	13	12	11	9	7	4	KMC-32/09-R2	18.5	25	154	148	140	129	117	102	82
KMC-32/01	2.2	3	18	17	15	14	13	11	8	KMC-32/09	18.5	25	162	156	147	136	124	109	88
KMC-32/02-R2	3.0	4	29	28	26	23	20	16	11	KMC-32/10-R2	18.5	25	175	166	157	146	131	115	91
KMC-32/02	4.0	5.5	36	34	32	29	27	23	18	KMC-32/10	18.5	25	182	173	164	152	138	122	98
KMC-32/03-R2	5.5	7.5	47	44	41	38	33	28	21	KMC-32/11-R2	22	30	193	184	173	164	146	128	102
KMC-32/03	5.5	7.5	54	51	48	44	40	35	27	KMC-32/11	22	30	200	191	180	168	153	135	109
KMC-32/04-R2	7.5	10	65	62	58	53	46	40	30	KMC-32/12-R2	22	30	211	201	189	178	160	140	113
KMC-32/04	7.5	10	72	69	65	59	53	47	37	KMC-32/12	22	30	218	208	196	184	267	147	120
KMC-32/05-R2	11	15	83	79	74	68	60	52	41	KMC-32/13-R2	30	40	230	218	206	193	174	153	124
KMC-32/05	11	15	90	86	81	74	67	59	47	KMC-32/13	30	40	237	225	213	200	181	160	131
KMC-32/06-R2	11	15	101	97	90	83	74	65	51	KMC-32/14-R2	30	40	247	235	222	210	189	165	135
KMC-32/06	11	15	108	104	97	90	81	72	57	KMC-32/14	30	40	255	242	229	216	196	172	142
KMC-32/07-R2	15	20	119	114	107	98	88	78	60	KMC-32/15-R2	30	40	266	253	239	224	203	178	145
KMC-32/07	15	20	126	121	113	105	95	85	67	KMC-32/15	30	40	274	260	246	231	210	185	152
KMC-32/08-R2	15	20	136	131	123	114	102	90	71	KMC-32/16-R2	30	40	284	270	255	240	218	190	156
KMC-32/08	15	20	144	138	130	120	109	97	77	KMC-32/16	30	40	292	277	262	246	225	197	163

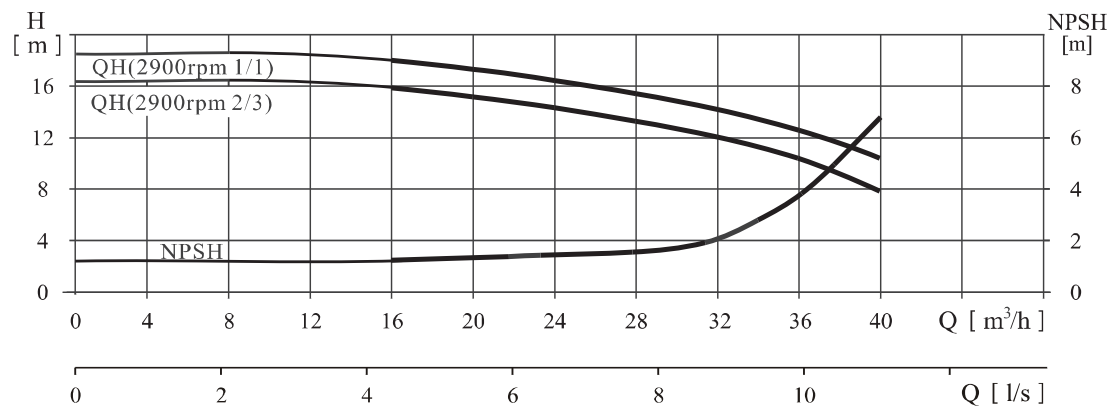
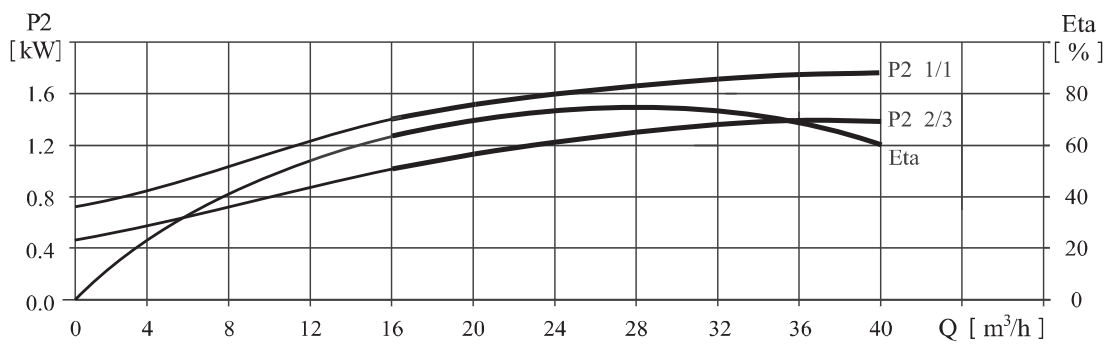

In view of continuous improvements in our design and process, the information, dimensions and specifications given herein are subject to change without notice.

Dimension & Weight Details

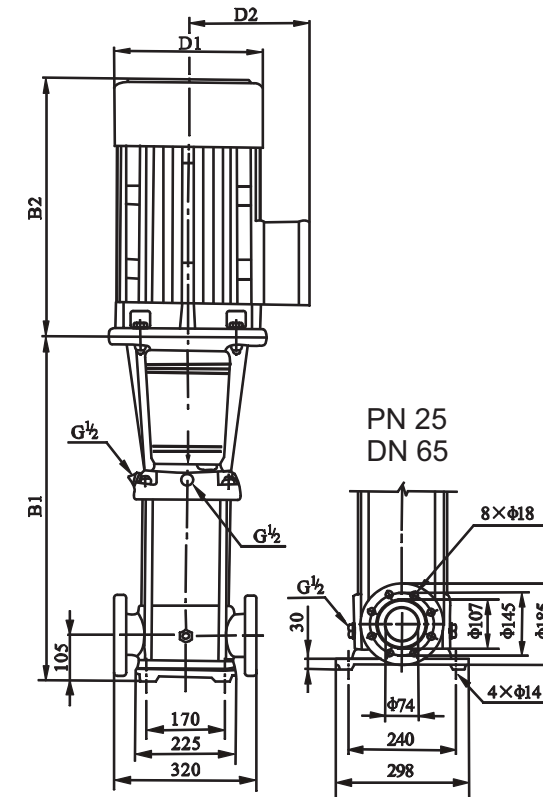

Model	Dimensions (mm)					Weight (kg)
	B1	B2	B1+B2	D1	D2	
KMC-32/01-R1/32-01	505	333	838	190	155	67
KMC-32/02-R2/32-02	575	370	945	230	185	83
KMC-32/03-R2/32-03	645	435	1080	260	208	100
KMC-32/04-R2/32-04	715	435	1150	260	208	109
KMC-32/05-R2/32-05	890	580	1470	350	260	181
KMC-32/06-R2/32-06	960	580	1540	350	260	185
KMC-32/07-R2/32-07	1030	580	1610	350	260	199
KMC-32/08-R2/32-08	1100	580	1680	350	260	203
KMC-32/09-R2/32-09	1170	610	1780	350	260	222
KMC-32/10-R2/32-10	1240	610	1850	350	260	227
KMC-32/11-R2/32-11	1310	645	1955	360	285	272
KMC-32/12-R2/32-12	1380	645	2025	360	285	276
KMC-32/13-R2/32-13	1450	705	2155	400	310	337
KMC-32/14-R2/32-14	1520	705	2225	400	310	341
KMC-32/15-R2/32-15	1590	705	2295	400	310	345
KMC-32/16-R2/32-16	1660	705	2365	400	310	350

Replace 3rd digit in model name as 'S' for SS 304 Pump housing & Pump Cover and 'N' for SS316 Pump housing & Pump Cover. Suffix 'S' for single phase & 'T' for three phase motor.
By Default Pump will be supplied with round flange connection.

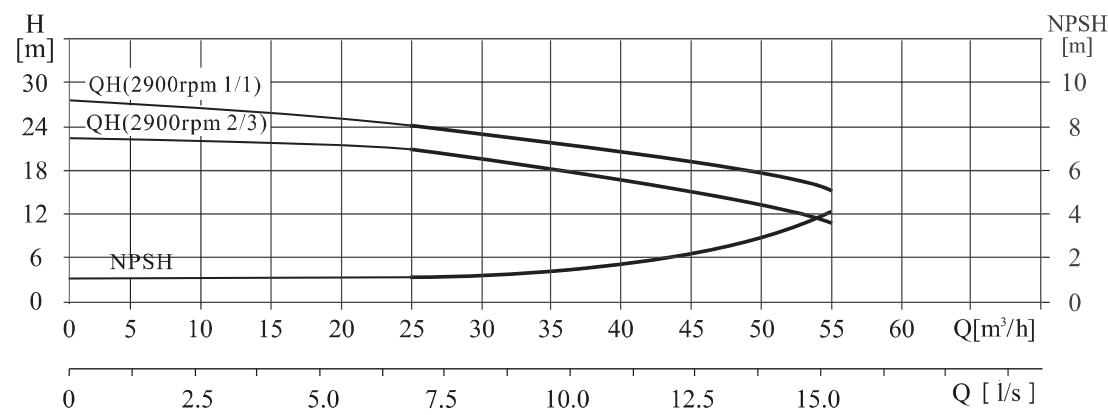
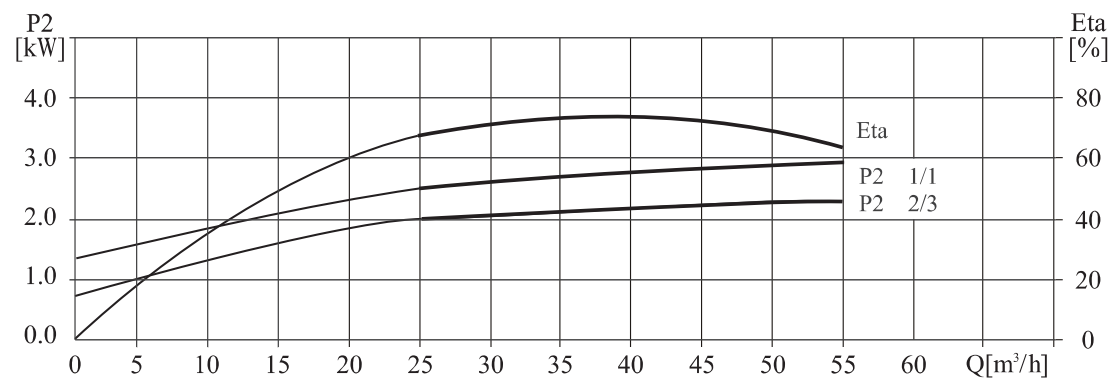
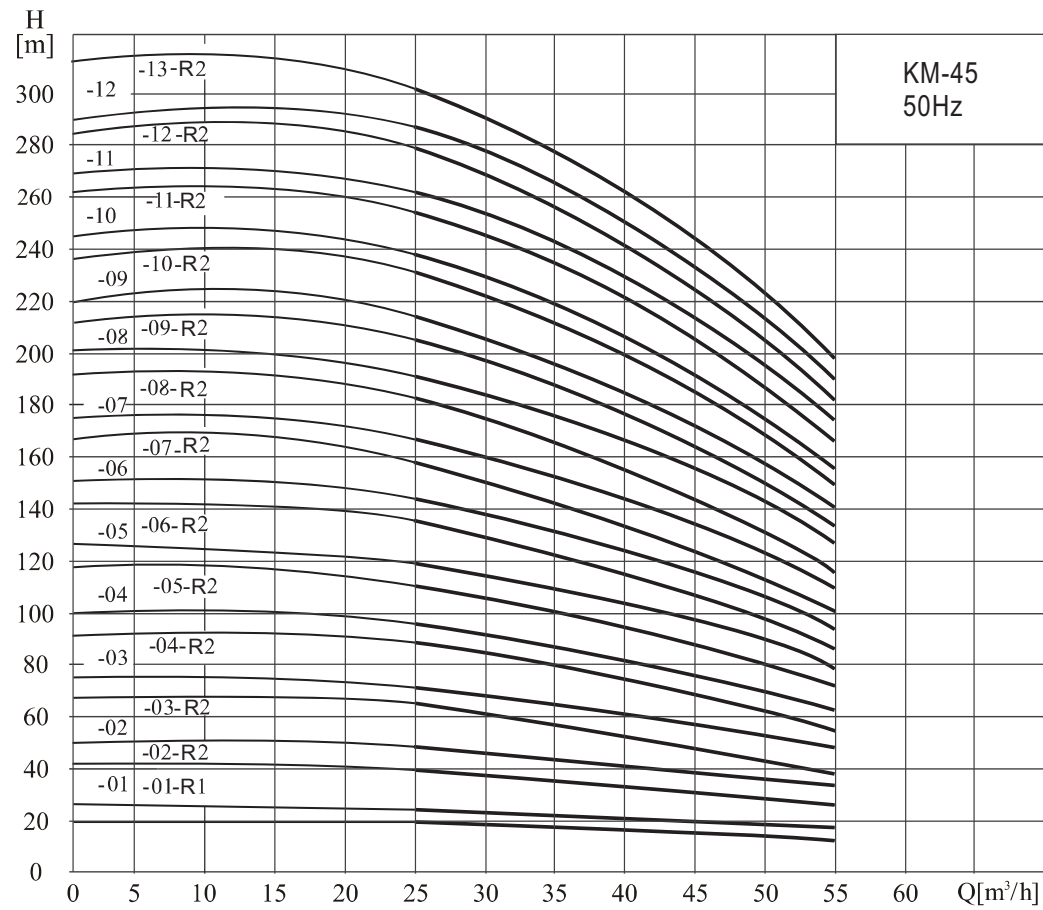

In view of continuous improvements in our design and process, the information, dimensions and specifications given herein are subject to change without notice.

Performance Table

2900 rpm

Model	Power		Q (m³/h)	25	30	35	40	45	50	55
	kW	HP								
KMC-45-01-R1	3	4	H (m)	20	19	18	17	15	13	11
KMC-45-01	4	5.5		24	23	22	21	19	18	16
KMC-45-02-R2	5.5	7.5		40	38	36	33	30	27	23
KMC-45-02	7.5	10		48	46	44	42	39	35	31
KMC-45-03-R2	11	15		63	61	58	54	50	44	38
KMC-45-03	11	15		71	69	66	63	58	53	47
KMC-45-04-R2	15	20		87	84	80	75	69	62	54
KMC-45-04	15	20		95	92	88	84	78	71	62
KMC-45-05-R2	18.5	25		111	107	102	94	88	80	69
KMC-45-05	18.5	25		119	115	110	105	97	88	78
KMC-45-06-R2	22	30		135	130	124	117	108	97	85
KMC-45-06	22	30		143	138	132	125	116	106	93
KMC-45-07-R2	30	40		158	152	146	138	127	115	100
KMC-45-07	30	40	166	161	154	146	135	124	109	
KMC-45-08-R2	30	40	182	175	168	159	146	133	116	
KMC-45-08	30	40	190	184	176	167	154	141	124	
KMC-45-09-R2	30	40	205	198	190	180	166	150	132	
KMC-45-9	37	50	214	207	198	188	174	159	140	
KMC-45-10-R2	37	50	230	221	212	200	185	168	147	
KMC-45-10	37	50	238	230	220	209	193	177	155	
KMC-45-11-R2	45	60	255	246	236	223	206	188	165	
KMC-45-11	45	60	263	255	244	232	214	196	173	
KMC-45-12-R2	45	60	280	270	259	245	226	206	181	
KMC-45-12	45	60	289	280	268	255	236	216	190	
KMC-45-13-R2	45	60	305	294	282	267	247	225	198	

Dimension & Weight Details

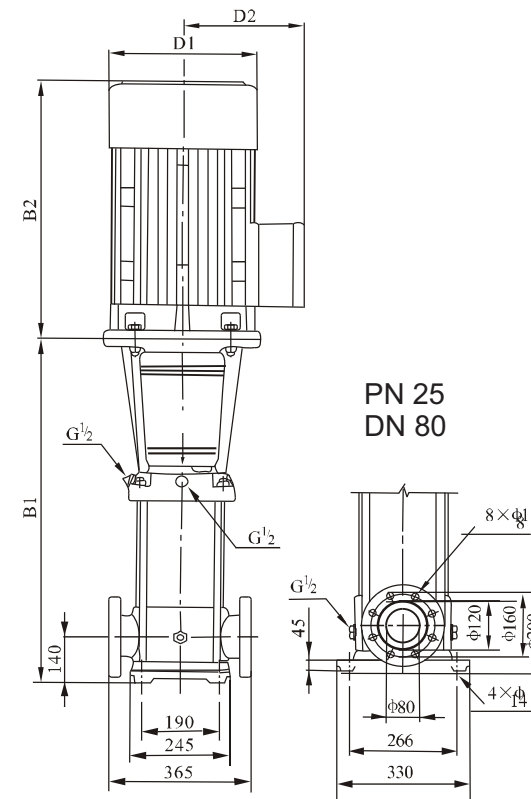

Model	Dimensions (mm)					Weight (kg)
	B1	B2	B1+B2	D1	D2	
KMC-45-01-R1	561	370	931	230	185	89
KMC-45-01	561	370	931	230	185	89
KMC-45-02-R2	641	435	1076	260	208	108
KMC-45-02	641	435	1076	260	208	108
KMC-45-03-R2	826	580	1406	350	260	183
KMC-45-03	826	580	1406	350	260	183
KMC-45-04-R2	906	580	1486	350	260	197
KMC-45-04	906	580	1486	350	260	197
KMC-45-05-R2	986	610	1596	350	260	221
KMC-45-05	986	610	1596	350	260	221
KMC-45-06-R2	1066	645	1711	360	285	261
KMC-45-06	1066	645	1711	360	285	261
KMC-45-07-R2	1146	705	1851	400	310	320
KMC-45-07	1146	705	1851	400	310	320
KMC-45-08-R2	1226	705	1931	400	310	324
KMC-45-08	1226	705	1931	400	310	324
KMC-45-09-R2	1306	705	2011	400	310	328
KMC-45-9	1306	740	2011	400	310	328
KMC-45-10-R2	1386	740	2091	400	310	355
KMC-45-10	1386	740	2091	400	310	355
KMC-45-11-R2	1466	740	2206	450	345	426
KMC-45-11	1466	740	2206	450	345	426
KMC-45-12-R2	1546	740	2286	450	345	432
KMC-45-12	1546	740	2286	450	345	432
KMC-45-13-R2	1626	740	2366	450	345	438

Replace 3rd digit in model name as 'S' for SS 304 Pump housing & Pump Cover and 'N' for SS316 Pump housing & Pump Cover. Suffix 'S' for single phase & 'T' for three phase motor.
By Default Pump will be supplied with round flange connection.

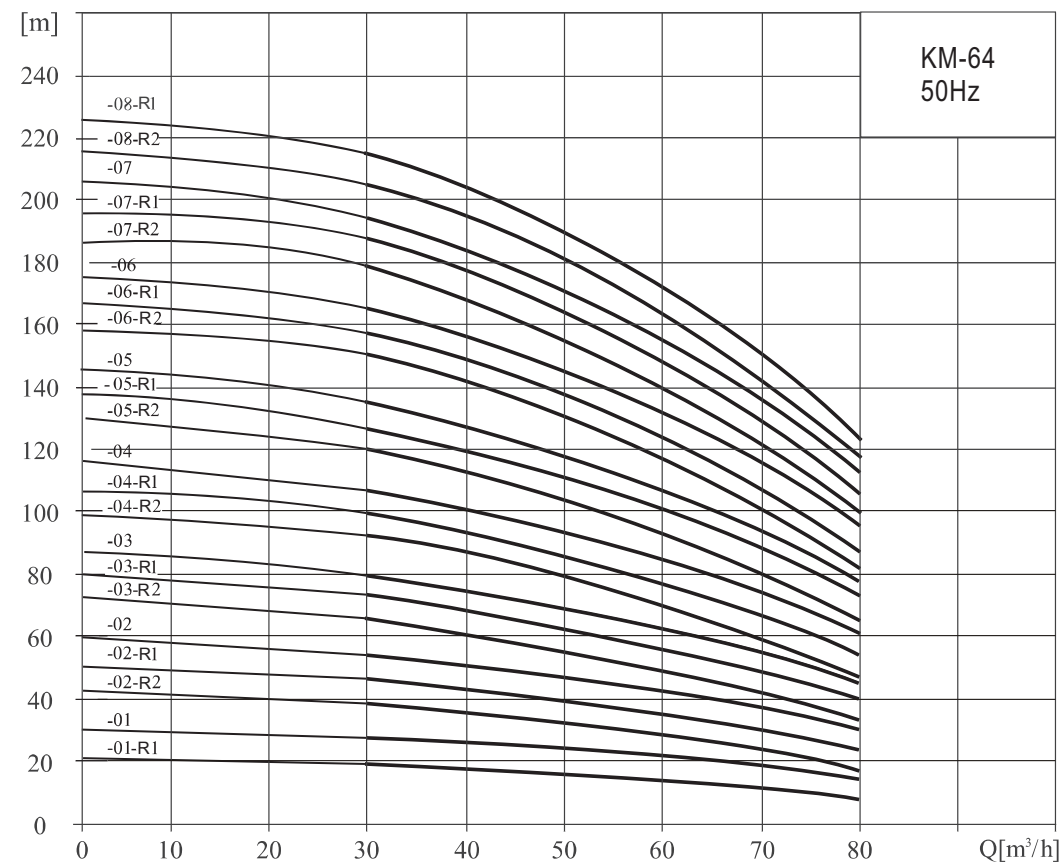

Performance Table

2900 rpm

Model	Power		Q (m³/h)	30	40	50	60	64	70	80
	kW	HP								
KMC-64-01-R1	4	5.5	H (m)	19	18	16	14	13	11	8
KMC-64-01	5.5	7.5		27	25	23	21	20	18	15
KMC-64-02-R2	7.5	10		39	36	33	29	27	23	17
KMC-64-02-R1	11	15		46	44	40	36	34	30	24
KMC-64-02	11	15		53	51	47	43	41	37	30
KMC-64-03-R2	15	20		66	62	56	50	47	41	32
KMC-64-03-R1	15	20		73	69	63	57	54	48	39
KMC-64-03	18.5	25		80	76	70	64	61	55	46
KMC-64-04-R2	18.5	25		92	87	80	71	67	60	47
KMC-64-04-R1	22	30		100	94	87	78	74	67	54
KMC-64-04	22	30		107	101	94	85	81	74	61
KMC-64-05-R2	30	40		121	114	105	95	89	80	64
KMC-64-05-R1	30	40		128	121	112	102	96	87	71
KMC-64-05	30	40		136	129	119	109	103	94	78
KMC-64-06-R2	30	40		150	142	131	118	111	101	81
KMC-64-06-R1	37	50		157	149	138	125	118	108	88
KMC-64-06	37	50		164	156	145	132	125	115	95
KMC-64-07-R2	37	50		179	169	156	141	133	121	99
KMC-64-07-R1	37	50		186	176	163	148	141	128	106
KMC-64-07	45	60		193	183	170	155	148	135	112
KMC-64-08-R2	45	60		207	196	182	164	156	142	116
KMC-64-08-R1	45	60		215	203	189	171	163	149	123

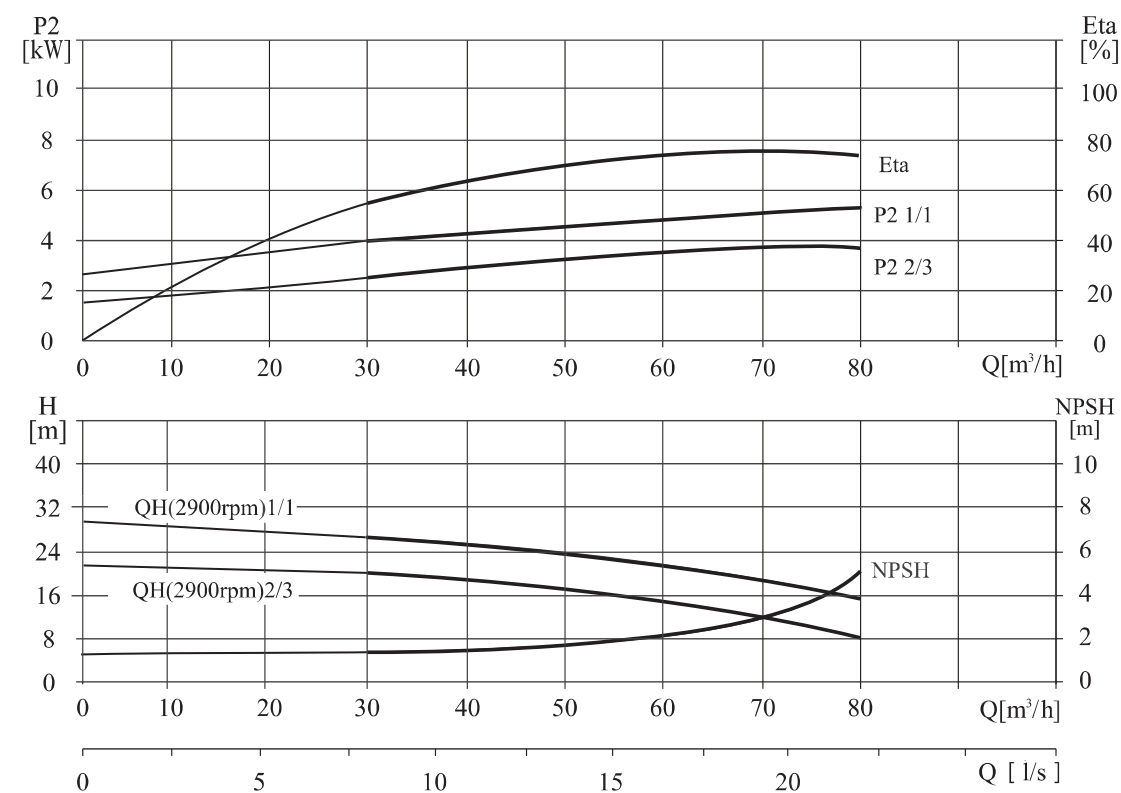

Dimension & Weight Details

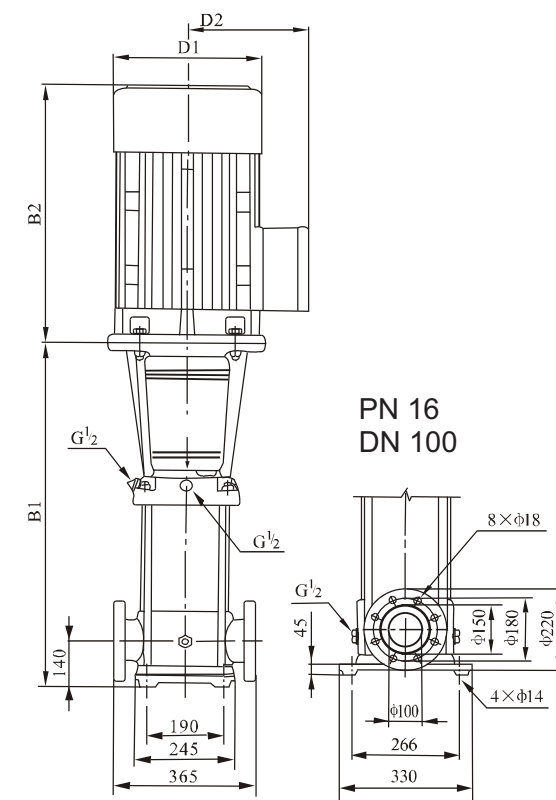

Model	Dimensions (mm)					Weight (kg)
	B1	B2	B1+B2	D1	D2	
KMC-64-01-R1	561	370	931	230	188	93
KMC-64-01	561	435	996	260	208	105
KMC-64-02-R2	644	435	1079	260	208	110
KMC-64-02-R1	754	580	1334	350	260	182
KMC-64-02	754	580	1334	350	260	182
KMC-64-03-R2	836	580	1416	350	260	197
KMC-64-03-R1	836	580	1416	350	260	197
KMC-64-03	836	610	1416	330	260	221
KMC-64-04-R2	919	610	1529	350	260	225
KMC-64-04-R1	919	645	1564	360	285	258
KMC-64-04	919	645	1564	400	285	258
KMC-64-05-R2	1001	705	1706	400	310	317
KMC-64-05-R1	1001	705	1706	400	310	231
KMC-64-05	1001	705	1706	400	310	231
KMC-64-06-R2	1084	705	1789	400	310	325
KMC-64-06-R1	1084	705	1789	400	310	349
KMC-64-06	1084	705	1871	400	310	349
KMC-64-07-R2	1166	705	1871	400	310	353
KMC-64-07-R1	1166	705	1871	460	310	353
KMC-64-07	1166	740	1906	460	340	420
KMC-64-08-R2	1248	740	1988	460	340	424
KMC-64-08-R1	1248	740	1988	460	340	424

In view of continuous improvement in design process, the information, dimensions and specifications given herein are subject to change without notice.

Replace 3rd digit in model name as 'S' for SS 304 Pump housing & Pump Cover and 'N' for SS316 Pump housing & Pump Cover. Suffix 'S' for single phase & 'T' for three phase motor. By Default Pump will be supplied with round flange connection.

2900 rpm

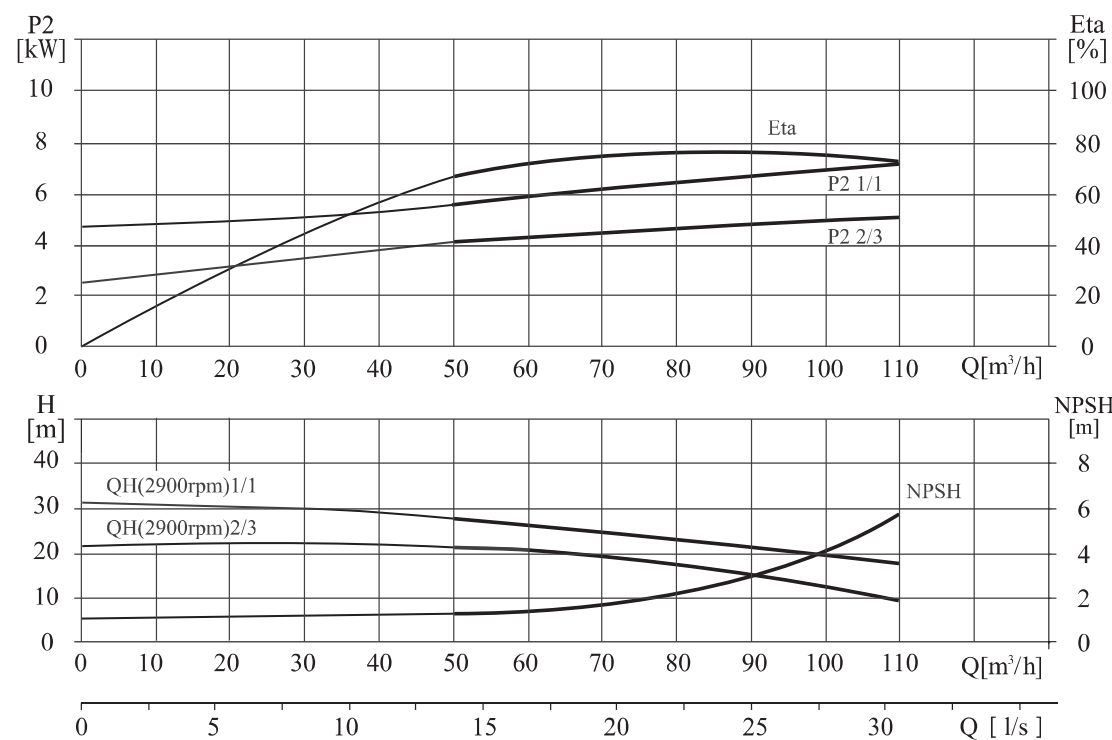
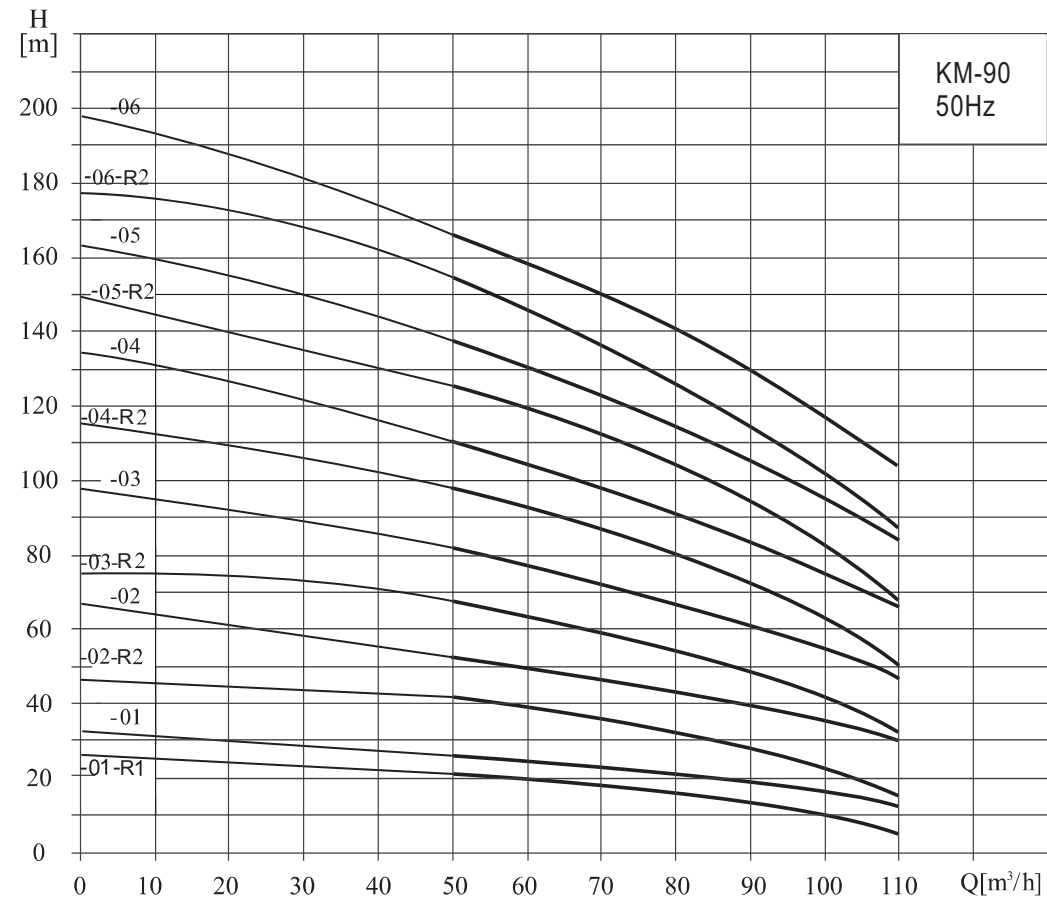

Performance Table

Model	Power		Q (m³/h)	50	60	70	80	90	100	110
	kW	HP								
KMC-90-01-R1	5.5	7.5	H (m)	22	19	17	16	13	10	6
KMC-90-01	7.5	10		25	24	22	21	19	16	12
KMC-90-02-R2	11	15		41	39	36	32	28	22	15
KMC-90-02	15	20		53	50	47	44	40	236	30
KMC-90-03-R2	18.5	25		68	65	60	55	49	41	32
KMC-90-03	22	30		81	77	72	67	62	55	48
KMC-90-04-R2	30	40		98	93	87	80	72	62	50
KMC-90-04	30	40		110	105	100	92	84	64	66
KMC-90-05-R2	37	50		126	120	113	104	93	81	68
KMC-90-05	37	50		139	131	124	115	106	94	83
KMC-90-06-R2	45	60		155	148	139	129	117	102	86
KMC-90-06	45	60		168	160	150	141	130	117	103

Dimension & Weight Details

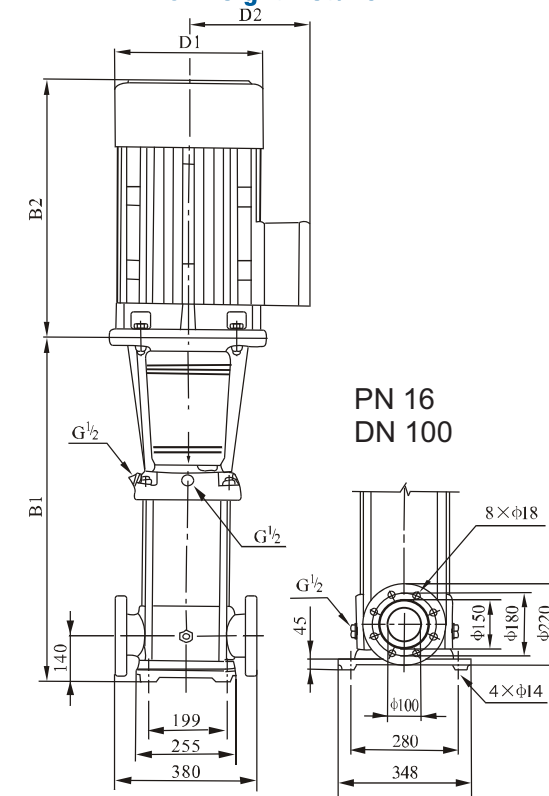

Model	Dimensions (mm)					Weight (kg)
	B1	B2	B1+B2	D1	D2	
KMC-90-01-R1	571	435	1006	260	208	105
KMC-90-01	571	435	1006	260	208	110
KMC-90-02-R2	773	580	1353	350	260	181
KMC-90-02	773	580	1353	350	260	192
KMC-90-03-R2	865	610	1475	350	260	215
KMC-90-03	865	645	1510	360	285	252
KMC-90-04-R2	957	705	1662	400	310	312
KMC-90-04	957	705	1662	400	310	312
KMC-90-05-R2	1049	705	1754	400	310	336
KMC-90-05	1049	705	1754	400	310	336
KMC-90-06-R2	1141	740	1881	460	340	407
KMC-90-06	1141	740	1881	460	340	407

In view of continuous improvements in our design and process, the information, dimensions and specifications given herein are subject to change without notice.

Replace 3rd digit in model name as 'S' for SS 304 Pump housing & Pump Cover and 'N' for SS316 Pump housing & Pump Cover. Suffix 'S' for single phase & 'T' for three phase motor. By Default Pump will be supplied with round flange connection.

2900 rpm

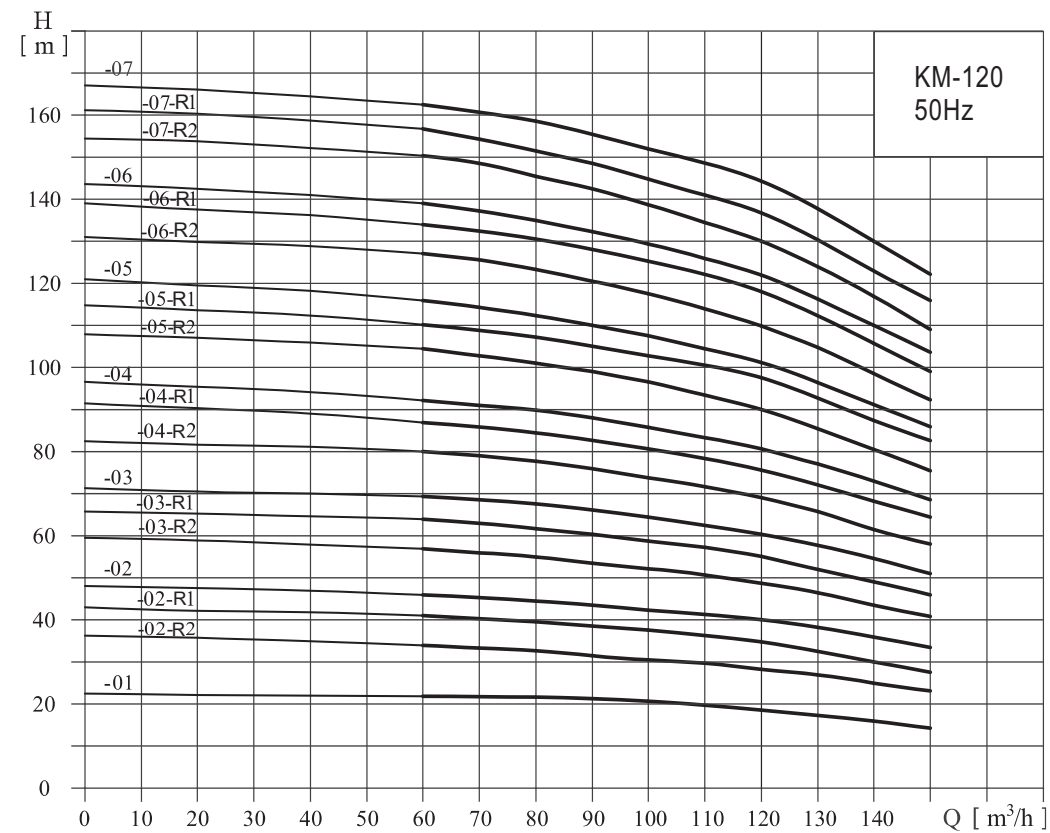

Performance Table

Model	Power		Q (m³/h)	H (m)											
	kW	HP		60	70	80	90	100	110	120	130	140	150		
KMC-120-01	11	15	22	21.8	21.6	21	20.5	19.5	18.5	17	16	15			
KMC-120-02R2	15	20	34	33.6	33	31	30.2	30	28.5	27	25	24			
KMC-120-02R1	18.5	25	41	40	39.5	38.5	37	36.5	34.5	32.5	30	27.5			
KMC-120-02	22	30	46	45	44.5	43.5	42.4	41	40	38	36	33.5			
KMC-120-03R2	30	40	57	56	55	53.5	52	51	49	46.5	43.5	41			
KMC-120-03R1	30	40	64	63	62	60	58.5	57.5	55.5	52	49	46			
KMC-120-03	30	40	69.5	68.5	67.5	66	64.5	62.5	61	57.5	54.5	51			
KMC-120-04R2	37	50	80.5	79	78	76	73.5	72	69	66	61.5	58			
KMC-120-04R1	37	50	87	86	84.5	82	80	78	76	72	68	64.5			
KMC-120-04	45	60	92.5	91	90	88	85.5	83	81	77	73	68.5			
KMC-120-05R2	45	60	104.5	103	101	99	96	93	90	85.5	80.5	75.5			
KMC-120-05R1	45	60	110.5	109	107.5	105	102	100	97	92.5	86.5	83			
KMC-120-05	55	75	115.5	114	113	110	107.5	104.5	101.5	96	91	86			
KMC-120-06R2	55	75	128	125.5	123	121	117.5	113.5	110	104.5	98.5	92.5			
KMC-120-06R1	55	75	134	132	130.5	127	124	121	118	111	105	100			
KMC-120-06	75	100	139	137	135	132	128.5	126	123	116	110	104			
KMC-120-07R2	75	100	151	148	145.5	143	138.5	134	130	123.5	116.5	109			
KMC-120-07R1	75	100	156.5	154	152	148.5	144.5	141	137.5	130	123	116.5			
KMC-120-07	75	100	162.5	160.5	158.5	155	151	148	145	137	129	123			

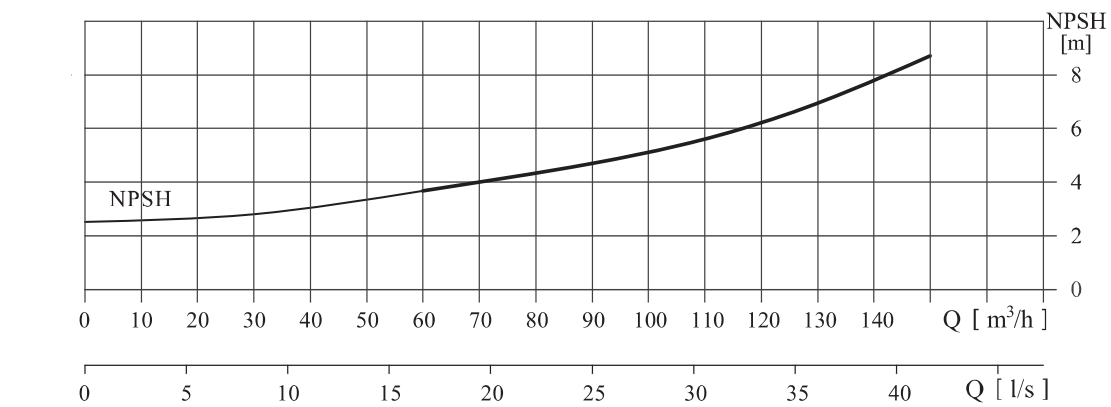
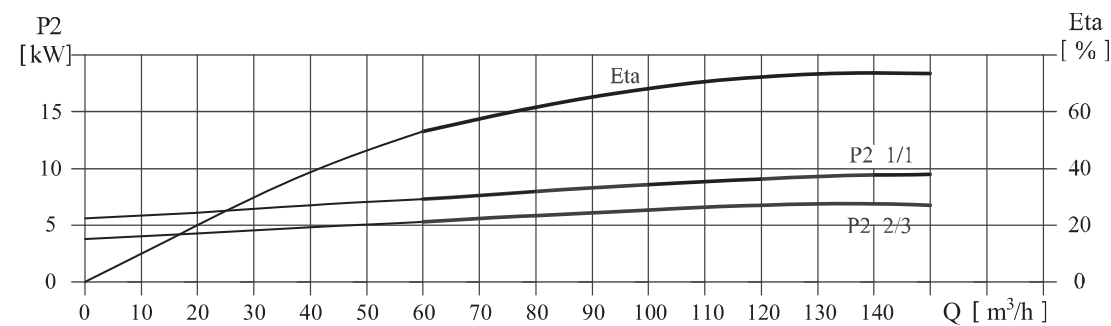

Dimension & Weight Details

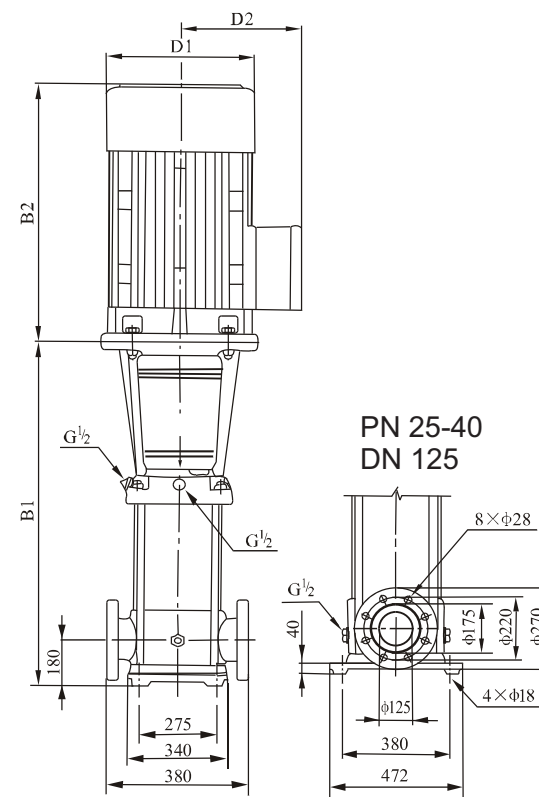

Model	Dimensions (mm)					Weight (kg)
	B1	B2	B1+B2	D1	D2	
KMC-120-01	840	580	1420	350	260	230
KMC-120-02R2	1000	580	1580	350	260	245
KMC-120-02R1	1000	610	1610	350	260	250
KMC-120-02	1000	645	1645	360	285	285
KMC-120-03R2	1160	705	1645	400	310	358
KMC-120-03R1	1160	705	1645	400	310	360
KMC-120-03	1160	705	2025	400	310	360
KMC-120-04R2	1320	705	2025	400	310	400
KMC-120-04R1	1320	705	2060	400	310	400
KMC-120-04	1320	740	2220	460	340	460
KMC-120-05R2	1480	740	2220	460	340	470
KMC-120-05R1	1480	740	2220	460	340	470
KMC-120-05	1510	810	2320	550	370	575
KMC-120-06R2	1670	810	2480	550	370	585
KMC-120-06R1	1670	810	2480	550	370	585
KMC-120-06	1670	870	2540	580	410	705
KMC-120-07R2	1830	870	2700	580	410	713
KMC-120-07R1	1830	870	2700	580	410	715
KMC-120-07	1830	870	2700	580	410	715

In view of continuous improvements in our design and process, the information, dimensions and specifications given herein are subject to change without notice.

Replace 3rd digit in model name as 'S' for SS 304 Pump housing & Pump Cover and 'N' for SS316 Pump housing & Pump Cover. Suffix 'S' for single phase & 'T' for three phase motor. By Default Pump will be supplied with round flange connection.

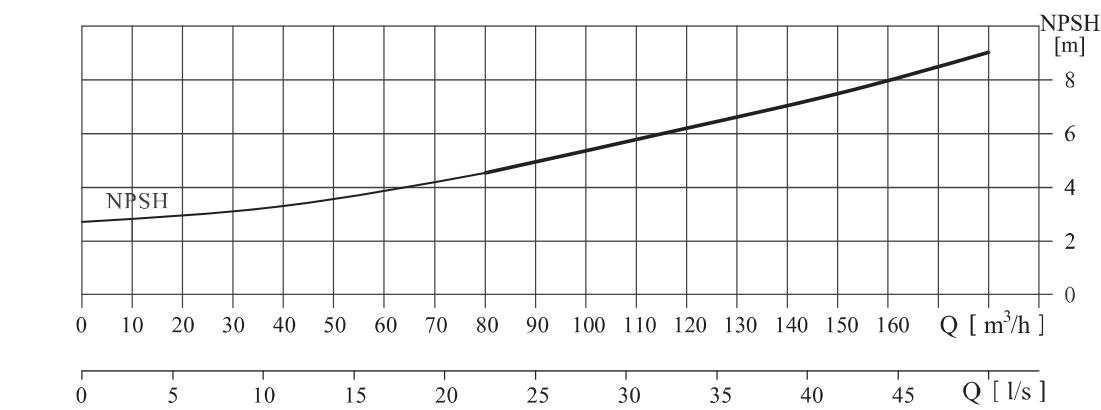
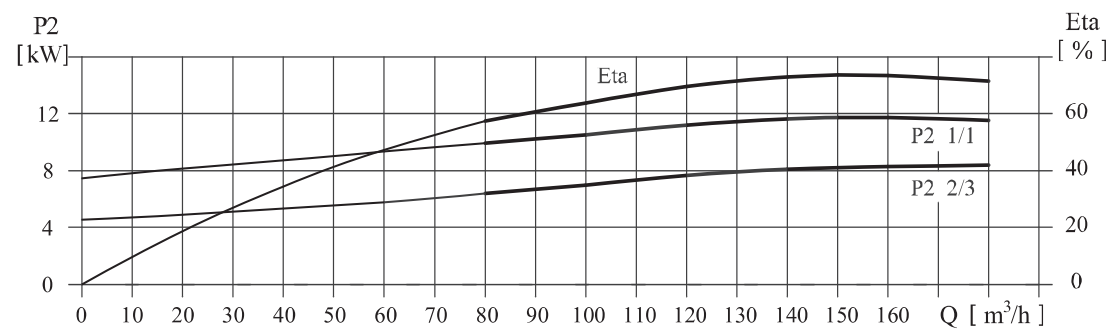
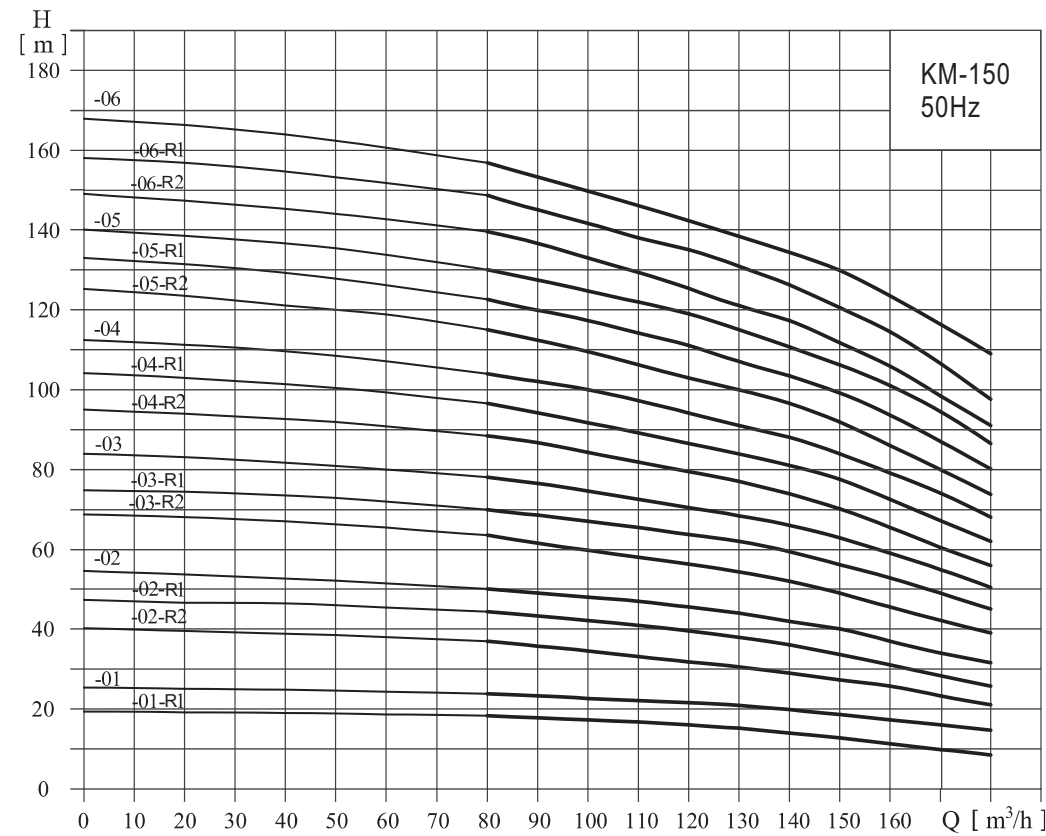

In view of continuous improvements in our design and process, the information, dimensions and specifications given herein are subject to change without notice.

Performance Table

2900 rpm

Model	Power		Q (m³/h)	H (m)											
	kW	HP		80	90	100	110	120	130	140	150	160	170	180	
KMC-150-01-R1	11	15	18.3	17.8	17.3	17	16	15	14	12.5	11	10	8.5		
KMC-150-01	15	20	24	23	22.5	22	21.5	20.5	20	18.5	17	16	15		
KMC-150-02-R2	18.5	25	37	35.5	34	33	32	31	29	27.5	26	23	21		
KMC-150-02-R1	22	30	44.5	43	42	40	39	38.5	37.5	35	33	30	27		
KMC-150-02	30	40	50	49	48	47	45.5	44	42	40	37	34	32		
KMC-150-03-R2	30	40	63.5	61	59	57.5	56	54.5	53	49	45.5	42	39		
KMC-150-03-R1	37	50	70	68	67	65	63	62	60	56	53	49	45		
KMC-150-03	37	50	78	76.5	75	73	70.5	68	66	63	59	55	50.5		
KMC-150-04-R2	45	60	89	87	84	81.5	79	77	74.5	70.5	65.5	60	56		
KMC-150-04-R1	45	60	96.5	94	91.5	89	86.5	84	81.5	77	72.5	67	62		
KMC-150-04	55	75	104	102	100	97	95	91	88	84	79.5	74	68		
KMC-150-05-R2	55	75	115	112	109	106	102.5	100	97	92	86	79	73.5		
KMC-150-05-R1	75	100	122.5	119.5	117	113.5	111.5	107.5	104.5	99	93.5	87	80		
KMC-150-05	75	100	130	127.5	125	121	119	115	111.5	106.5	101	94.5	86.5		
KMC-150-06-R2	75	100	140	137	133	130	126	121	118	112	106	98	91		
KMC-150-06-R1	75	100	148.5	145	141.5	137.5	135	131	127	120	114.5	106.5	97.5		
KMC-150-06	75	100	157	153	149	145	142	139.5	137	130	123.5	116	109		

Dimension & Weight Details

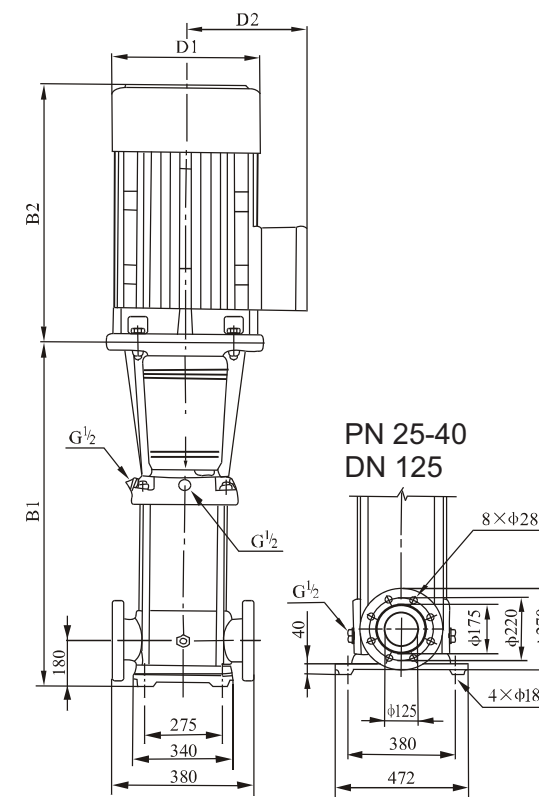

Model	Dimensions (mm)					Weight (kg)
	B1	B2	B1+B2	D1	D2	
KMC-150-01-R1	840	580	1420	350	260	235
KMC-150-01	840	580	1420	350	260	235
KMC-150-02-R2	1000	610	1610	350	260	250
KMC-150-02-R1	1000	645	1645	360	285	295
KMC-150-02	1000	705	1705	400	310	350
KMC-150-03-R2	1160	705	1865	400	310	360
KMC-150-03-R1	1160	705	1865	400	310	385
KMC-150-03	1160	705	1865	400	310	385
KMC-150-04-R2	1320	740	2060	460	340	460
KMC-150-04-R1	1320	740	2060	460	340	460
KMC-150-04	1350	810	2160	550	370	560
KMC-150-05-R2	1510	810	2320	550	370	570
KMC-150-05-R1	1510	870	2380	580	410	690
KMC-150-06	1510	870	2380	580	410	690
KMC-150-07-R2	1670	870	2540	580	410	700
KMC-150-07-R1	1670	870	2540	580	410	703
KMC-150-07	1670	870	2540	580	410	703

Replace 3rd digit in model name as 'S' for SS 304 Pump housing & Pump Cover and 'N' for SS316 Pump housing & Pump Cover. Suffix 'S' for single phase & 'T' for three phase motor. By Default Pump will be supplied with round flange connection.

2900 rpm

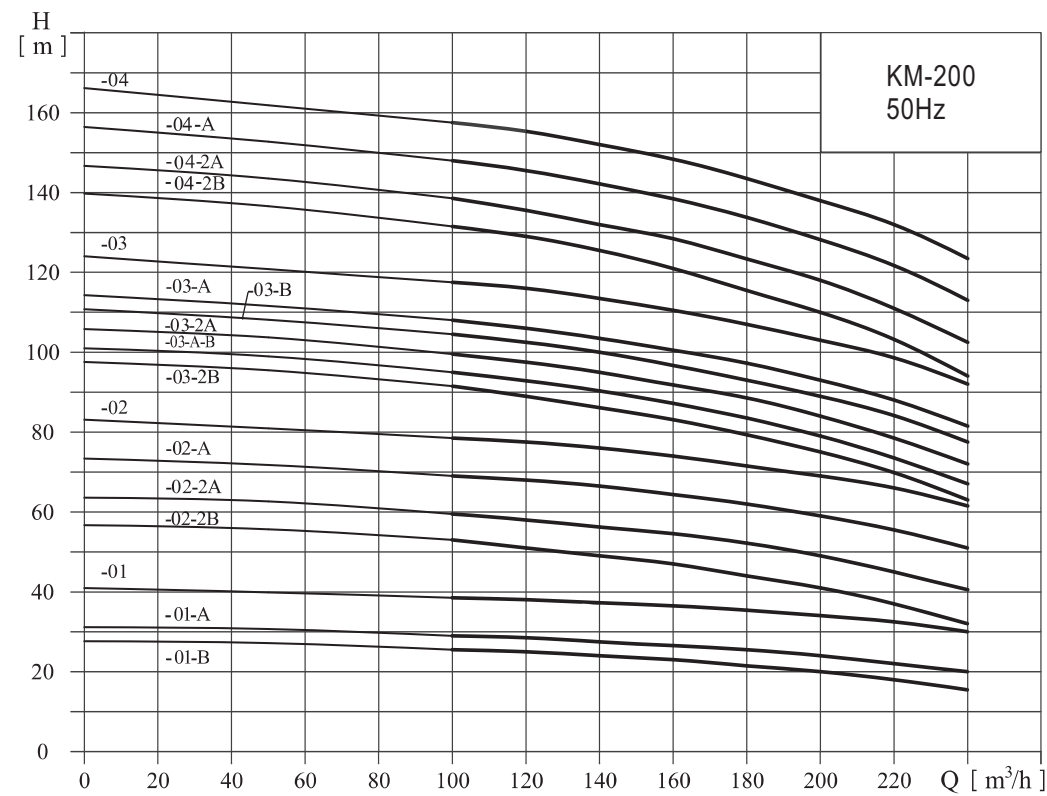

Performance Table

Model	Power		Q (m³/h)	H (m)																	
	kW	HP		100	120	140	160	180	200	220	240										
KMC-200-01-B	18.5	25		25.5	25	24	23	21.5	20	18	15.5										
KMC-200-01-A	22	30		29	28.5	27.5	26.5	25.5	24	22	20										
KMC-200-01	30	40		38.5	38	37.5	36.5	35	34	32.5	30										
KMC-200-02-2B	37	50		53	51	49	47	44	41	37	32										
KMC-200-02-2A	45	60		59.5	58	56	54	52.5	49	44.5	40.5										
KMC-200-02-A	55	75		69	68	66	64	62	59	55.5	51										
KMC-200-02	55	75		78.5	77.5	76	74	71.5	69	66	61.5										
KMC-200-03-2B	75	100		91.5	89	86.5	83.5	79	75	70	63										
KMC-200-03-A-B	75	100		95	93	90	87	83.5	79	73.5	67										
KMC-200-03-2A	75	100		99.5	97.5	94.5	91.5	89	84	78.5	72										
KMC-200-03-B	75	100		104.5	102.5	100	97	93	89	84.5	77.5										
KMC-200-0-3-A	75	100		108	106	103.5	100.5	97.5	93	88	81.5										
KMC-200-03	90	120		117.5	116	113.5	110.5	107	103	99	92										
KMC-200-04-2B	90	120		131.5	129	125.5	121	115.5	110	103.5	94										
KMC-200-04-2B	110	150		138.5	136	132	128	124	118	111	102.5										
KMC-200-04-A	110	150		148	145.5	142.5	138	134	128	122	113										
KMC-200-04	110	150		157.5	155.5	152.5	148	143.5	138	132.5	123.5										

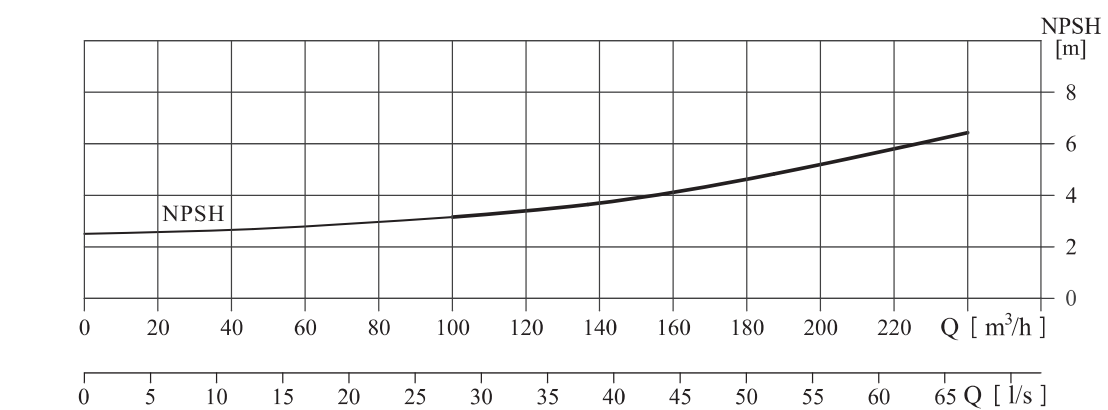
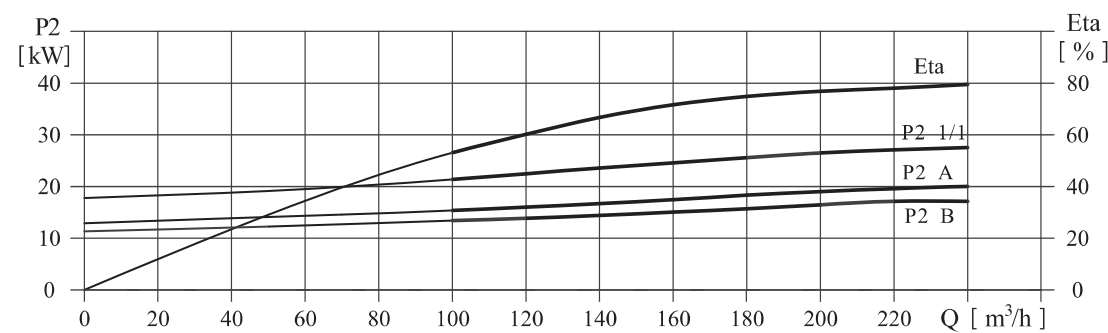

Dimension & Weight Details

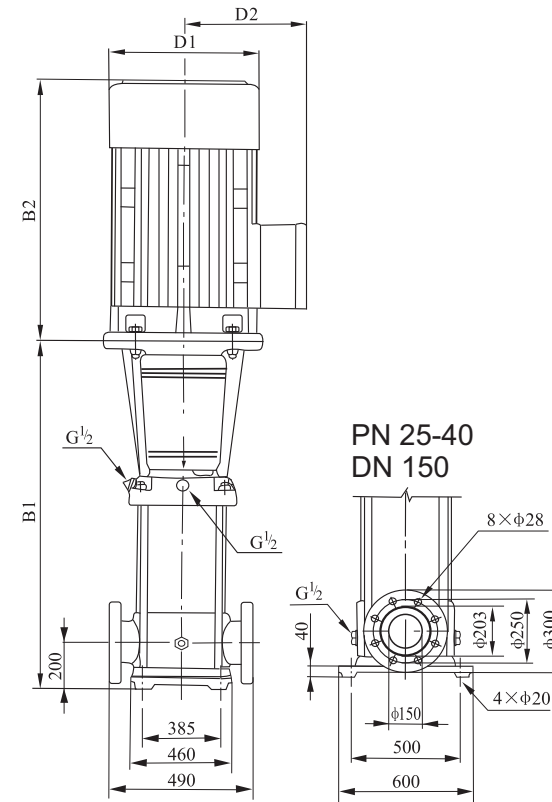

Model	Dimension (mm)					Weight (kg)
	B1	B2	B1+B2	D1	D2	
KMC-200-01-B	907	610	1517	350	260	311
KMC-200-01-A	907	645	1552	360	285	347
KMC-200-01	907	705	1612	400	310	403
KMC-200-02-B	1101	705	1806	400	310	447
KMC-200-02-2A	1101	740	1841	460	340	504
KMC-200-02-A	1131	810	1941	550	370	595
KMC-200-2	1131	810	1941	550	370	595
KMC-200-03-2B	1325	870	2195	580	410	748
KMC-200-03-A-B	1325	870	2195	580	410	748
KMC-200-03-2A	1325	870	2195	580	410	748
KMC-200-03-B	1325	870	2195	580	410	748
KMC-200-0-3-A	1325	870	2195	580	410	748
KMC-200-03	1325	920	2245	580	410	816
KMC-200-04-2B	1519	920	2439	580	410	830
KMC-200-04-2B	1519	1060	2579	1180	550	1180
KMC-200-04-A	1519	1060	2579	1180	550	1180
KMC-200-04	1519	1060	2579	1180	550	1180

In view of continuous improvements in our design and process, the information, dimensions and specifications given herein are subject to change without notice.

Replace 3rd digit in model name as 'S' for SS 304 Pump housing & Pump Cover and 'N' for SS316 Pump housing & Pump Cover. Suffix 'S' for single phase & 'T' for three phase motor. By Default Pump will be supplied with round flange connection.